



WHERE QUALITY COMES FIRST



Stainless steel side connection allows for quicker, less expensive installation

Hydro-Plus well tanks

Zilmet has over 50 years of experience in manufacturing high quality diaphragm well tanks

- *Produces over 7 million tanks and 1 million heat exchangers annually*
- *Fully vertically integrated, designing and manufacturing all diaphragms internally*

Zilmet has created a compact design with a seamless diaphragm that never stretches or creases. There are no bubbles or corners to trap sediment, inhibiting bacterial growth

technical features:

- *Seamless NSF 61 certified low permeability butyl diaphragm never creases and channels water directly to outlet, thus eliminating bacterial growth pockets*
- *MIG welding eliminates interior rough spots and sharp edges*
- *Low profile tank design with full membrane depth eliminates stretching of diaphragm, providing increased life cycle*
- *All diaphragms made by Zilmet specifically for each tank's dimensions*
- *Powder coated finish for a longer lasting, more durable finish*
- *5 year warranty on all models*
- *The Zilmet side connection advantages:*
 - *Easier and quicker installation*
 - *Less expensive installation*
 - *Less vulnerable to corrosion at connector*

material description

description	material
shell	carbon steel*
connection	stainless steel*
fixed membrane	butyl**
color	almond

* internally coated with powder for potable water applications

** for potable water applications

operating conditions

max. operating pressure	150 psi
operating temperature	210 °F
factory precharge	38 psi

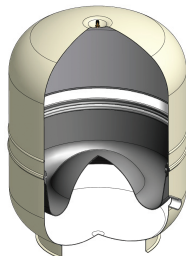

■ technical and dimensional data

Type	Model	Capacity	Diameter	Height	Connection Height	Connection Size	Precharge	System Drawdown	
		gallons	inches (ØD)	inches(H)	inches(E)	NPT (ØC)	psi	30-50 psi	40-60 psi
Inline	ZHP5	2.1	7.9	11.0		3/4"	38	0.7	0.6
Inline	ZHP12	4.8	10.6	13.7		3/4"	38	1.6	1.4
Inline	ZHP18	6.3	11.8	15.4		1"	38	2.2	1.9
Inline	ZHP104IL	9.2	15.0	14.2		1"	38	3.1	2.7
Inline	ZHP200IL	13.2	15.0	19.6		1"	38	4.5	3.9
Horizontal Model with Pump Bracket	ZHP200BH	13.2	15.0	16.5		1"	38	4.5	3.9
Stand Model	ZHP200F	13.2	15.0	19.9	6.0	1"	38	4.5	3.9
Stand Model	ZHP202	21.1	17.7	23.9	5.9	1"	38	7.2	6.2
Stand Model with Pump Bracket	ZHP202BV	21.1	17.7	24.4	5.9	1"	38	7.2	6.2
Horizontal Model with Pump Bracket	ZHP202BH	21.1	17.7	19.1		1"	38	7.2	6.2
Horizontal Spacemaker	ZHP202SM	21.1	17.7	18.1		1"	38	7.2	6.2
Stand Model	ZHP203	27.7	19.7	26.2	6.5	1 1/4"	38	9.5	8.2
Stand Model	ZHP204	39.6	19.7	35.3	8.5	1 1/4"	38	13.5	11.7
Stand Model	ZHP250	52.8	23.6	32.0	8.9	1 1/4"	38	18.0	15.6
Stand Model	ZHP251	66.0	24.8	37.7	9.6	1 1/4"	38	22.5	19.5
Stand Model	ZHP302	79.3	24.8	43.5	9.6	1 1/4"	38	27.0	23.4
Stand Model	ZHP350	105.7	24.8	57.1	9.6	1 1/4"	38	36.0	31.2
Stand Model	ZHP351	119	29.5	42.8	11.4	1 1/4"	38	40.6	35.1
Stand Model	ZHP400	132.1	29.5	52.8	11.4	1 1/4"	38	45.0	39.0
Stand Model	ZHP451	158.5	29.5	61.5	11.4	1 1/4"	38	54.0	46.8

■ zilmet well tank sizing chart

Gallons per Minute GPM	30/50 psig		40/60 psig	
	1 min	2 min	1 min	2 min
5	ZHP202	ZHP203	ZHP202	ZHP203
10	ZHP203	ZHP251	ZHP204	ZHP302
12	ZHP204	ZHP302	ZHP250	ZHP302
15	ZHP250	ZHP302	ZHP251	ZHP351
20	ZHP251	ZHP351	ZHP302	ZHP302 (2)
25	ZHP302	ZHP302 (2)	ZHP350	ZHP350 (2)
30	ZHP350	ZHP350 (2)	ZHP351	ZHP351 (2)
35	ZHP351	ZHP351 (2)	ZHP351	ZHP351 (2)

* Use this chart to properly size your well tank to prevent excessive wear and tear on your well pump and to reduce energy consumption. (2) indicates - two tanks required.

■ technical drawings

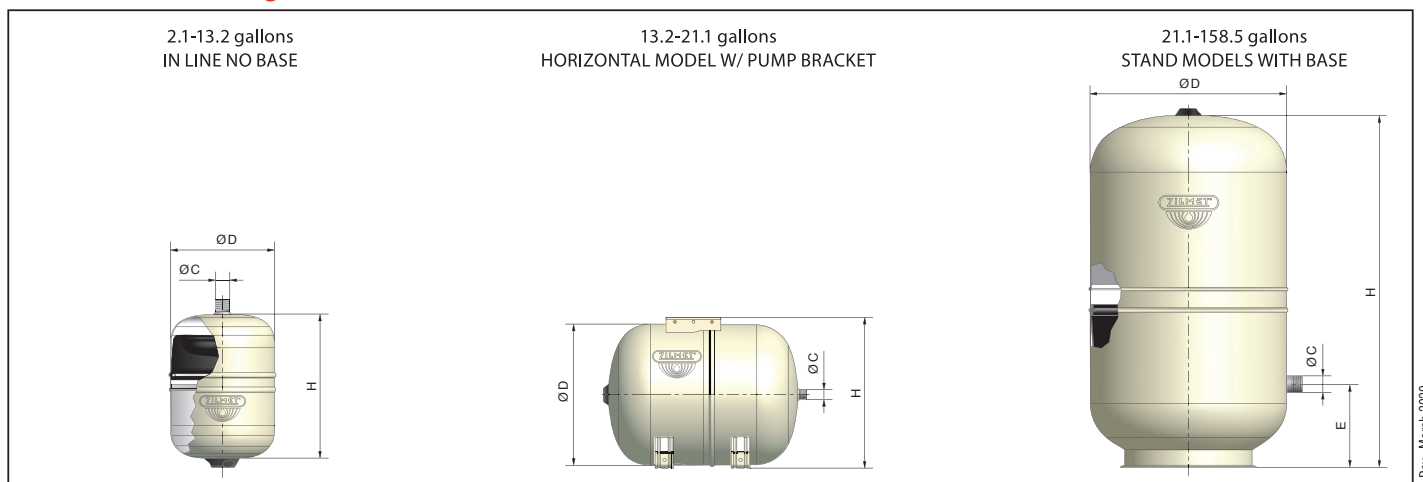

North American Headquarters
Zilmet USA
 400 Frenchtown Road
 East Greenwich, RI 02818
 Tel. 401-884-4943
 info@zilmetusa.com
 www.zilmetusa.com

Headquarters
 Via del Santo, 242 - 35010 Limena (PD) - Italy
 Tel. +39 049 7664901
 Fax +39 049 767321
 www.zilmet.it
 zilmet@zilmet.it

Production plants - Italy
 Limena (PD) Via del Santo, 242
 Via Visco, 2 • Via Colpi, 30
 Via Tamburin, 15/17
 Bagnoli di Sopra (PD) - Via V Strada, 21/23

Branches
 Zilmet Deutschland GmbH
 www.zilmet.de
 Zilmet USA
 www.zilmetusa.com
 Zilmet UK
 www.zilmet.co.uk