

COPPER SOLDERLESS LUGS • TYPES SLU & SAU

One hole, single collar

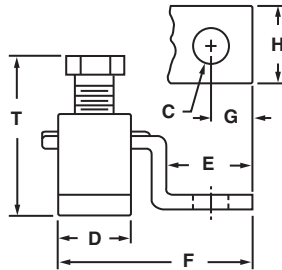

100% pure electrolytic copper for utmost efficiency.

Unique design of the concave pressure bar and V-bottom collar assures positive contact and firm, permanent grip. For tin plated—suffix catalog number “-TN”.

Catalog Number	Conductor Range (Copper Stranded)	Approximate Dimensions												Ampere Rating NEC		
		C		D		E		F		G		H			T	
		in	mm	in	mm	in	mm	in	mm	in	mm	in	mm		in	mm
SLU-25†	10, 12, 14	⁵ / ₃₂	3.96	⁹ / ₃₂	7.14	¹⁵ / ₃₂	5.55	¹⁵ / ₁₆	25.40	³ / ₁₆	4.76	⁵ / ₁₆	7.93	²¹ / ₃₂	16.66	25
SLU-35†	6, 8, 10, 12, 14	¹³ / ₆₄	5.15	⁷ / ₁₆	11.11	⁹ / ₁₆	12.70	¹¹ / ₈	30.16	⁷ / ₃₂	5.55	³ / ₈	9.52	³ / ₄	19.05	35-50
SAU-70†	4, 6, 8, 10, 12, 14	¹⁷ / ₆₄	6.74	⁷ / ₁₆	11.11	¹⁷ / ₃₂	13.49	¹¹ / ₄	33.33	¹ / ₄	6.35	¹ / ₂	12.70	¹³ / ₁₆	20.63	70
SLU-70†	2, 4, 6, 8	¹⁷ / ₆₄	6.74	¹ / ₂	12.70	¹¹ / ₁₆	18.25	¹⁷ / ₁₆	38.89	¹ / ₄	6.35	¹ / ₂	12.70	1	25.40	70-90
SLU-125	1/0, 1, 2, 4, 6, 8	¹⁷ / ₆₄	6.74	⁵ / ₈	15.87	⁷ / ₈	20.63	¹⁷ / ₈	50.00	⁷ / ₁₆	11.11	⁵ / ₈	15.87	¹¹ / ₃₂	34.13	125
SLU-175	3/0, 2/0, 1/0, 1, 2, 4	¹³ / ₃₂	10.31	³ / ₄	19.05	¹¹ / ₃₂	26.19	²¹ / ₄	53.97	⁷ / ₁₆	11.11	³ / ₄	19.05	¹⁹ / ₁₆	39.68	175
SLU-225	4/0, 3/0, 2/0, 1/0, 1, 2	¹¹ / ₃₂	8.73	1	25.40	¹³ / ₃₂	29.36	²³ / ₈	66.67	¹⁵ / ₃₂	12.70	1	25.40	¹³ / ₁₆	46.03	225
* SLU-300	350 MCM, 300 MCM, 250 MCM, 200 MCM, 4/0, 3/0, 2/0, 1/0	¹³ / ₃₂	10.31	¹¹ / ₄	31.75	¹⁹ / ₁₆	38.10	³⁷ / ₃₂	80.96	¹ / ₂	12.70	1	25.40	²⁵ / ₈	66.67	300
* SLU-400	500 MCM, 400 MCM, 350 MCM, 300 MCM, 250 MCM, 4/0, 3/0, 2/0, 1/0	¹³ / ₃₂	10.31	¹¹ / ₂	38.10	¹⁷ / ₈	49.21	⁴¹ / ₁₆	107.95	²⁹ / ₃₂	23.81	¹¹ / ₂	38.10	²³ / ₄	69.85	400
* SLU-650	1000 MCM, 900 MCM, 800 MCM, 750 MCM, 700 MCM, 600 MCM	¹⁷ / ₃₂	13.49	¹⁷ / ₈	47.62	²¹ / ₈	47.62	⁴⁵ / ₈	117.47	¹³ / ₁₆	30.16	2	50.80	³¹ / ₁₆	93.66	650

*Add suffix “C” for CSA Certified Product

†Slotted screw

MULTIPLE SOLDERLESS LUG • TYPE LU



Made from electrolytic copper for utmost efficiency. Screws are cadmium plated steel. Unique design of the concave pressure bar and V-bottom collar assures positive contact and firm, permanent grip. For tin plated—suffix catalog number “-TN”.

Catalog Number	Conductor Range (Copper Stranded)	Ampere Rating NEC
LU-2	2 No. 4/0, 2 No. 3/0, 2 No. 2/0	400
LU-4	2 No. 350 MCM, 2 No. 300 MCM, 2 No. 250 MCM 2 No. 4/0, 2 No. 200 MCM, 2 No. 3/0, 2 No. 2/0, 2 No. 1/0	600
LU-6	2 No. 500 MCM, 2 No. 400 MCM, 2 No. 350 MCM 2 No. 300 MCM, 2 No. 250 MCM, 2 No. 4/0	800