

Bronze Terminal Lugs - One Hole Tongue Type PNL

For use with one copper conductor

- Manufactured from high strength copper alloy for maximum conductivity and corrosion resistance
- Used for joining a wide range of copper conductors to equipment pads or bus bars
- Plated steel set screw provides high strength connection
- Annular serrations in conductor grooves of PNL-500 and PNL-1000 provide improved mechanical performance
- Flat bottoms allow for complete contact with mounting surface
- Inspection hole allows for visual confirmation of proper cable insertion
- Lug can be furnished electro-tin or silver plated
- For tin plating, suffix catalog number with “-TN”, “-SV” for silver plating

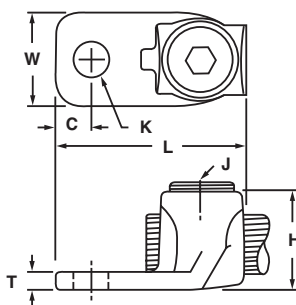

CATALOG NUMBER	CONDUCTOR RANGE	APPROXIMATE DIMENSIONS (IN.)							HEX SIZE
		C	K (DIA.)	H	L	T	W	J (SCREW THREAD)	
PNL-8	14 Sol. - 8 Str.	.19	.20	.44	.88	.09	.38	#12 - 24	Slot
PNL-4	14 Sol. - 4 Str.	.27	.27	.56	1.25	.14	.53	5/16 - 24	Slot
PNL-1/0	8 Sol. - 1/0 Str.	.38	.33	.78	1.59	.14	.73	1/2 - 20	1/4
PNL-250	6 Sol. - 250 kcmil	.44	.39	1.05	1.97	.13	.94	5/8 - 18	5/16
PNL-500	4 Sol. - 500 kcmil	.75	.53	1.47	3.00	.25	1.38	1 5/16 - 16	3/8
PNL-1000	500 - 1000 kcmil	.69	.56	2.00	3.88	.38	1.75	1 3/8 - 14	1/2