

MAC2 Series MC/AC Support Clips

Metal and wood stud, and flanges up to 1/16"

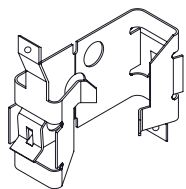

For Cable Sizes
14-2 Through 10-3
With Ground

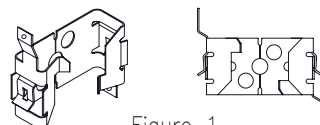

Figure 1

Double runs of MC/AC cable from structural members, wires, and rods

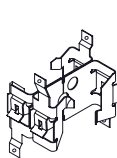

Figure 2

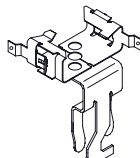

Figure 3

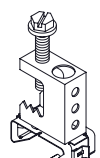

Figure 4

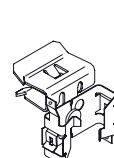

Figure 5

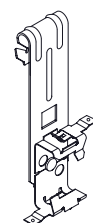

Figure 6

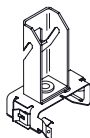

Figure 7

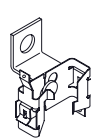

Figure 8

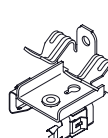

Figure 9

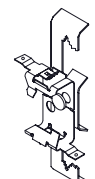

Figure 10

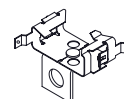

Figure 11

Part Number	Figure	Description (in [mm])	Attaches MC/AC to:
MAC2	1	Metal or wood stud and 1/16" [2] flange	
MAC2T	2	Supports 1 to 4 runs of MC/AC cable for metal stud	
MAC2ATA	3	Acoustical tee	
MAC2BC	4	1/8" [3] through 1/2" [13] flange	
MAC224SM	5	1/8" [3] through 1/4" [6] flange	
MAC258SM		5/16" [8] through 1/2" [13] flange	
MAC2912SM		1/2" [13] through 3/4" [19] flange	
MAC2VF14	6	1/16" [2] through 1/4" [6] C Purlin or vertical flange	
MAC2123	7	Z purlin	
MAC2AO	8	Offset bracket	
MAC224	9	1/8" [3] through 1/4" [6] flange - bottom mount, rotates 360°	
MAC258		5/16" [8] through 1/2" [13] flange - bottom mount, rotates 360°	
MAC2912		9/16" [14] through 3/4" [19] flange - bottom mount, rotates 360°	
MAC21318		13/16" [21] through 1-1/8" [28] flange - bottom mount, rotates 360°	
MAC24Z34	10	#12 through 1/4" [6] wire, plain or threaded rod and 1/8" [3] through 3/8" [10] flange	
MAC26Z34		3/8" [10] plain or threaded rod and 3/8" [10] through 9/16" [14] flange	
MAC2FB	11	Through metal stud	

*Note: MAC2 snaps apart for single applications. Assemblies do not have this feature.

WARNING:

1. Pentair products shall be installed and used only as indicated in Pentair product instruction sheets and training materials. Instruction sheets are available at www.erico.pentair.com and from your Pentair customer service representative.
2. PENTAIR products must never be used for a purpose other than the purpose for which they were designed or in a manner that exceeds specified load ratings.
3. All instructions must be **completely** followed to ensure proper and safe installation and performance.
4. Improper installation, misuse, misapplication or other failure to completely follow Pentair's instructions and warnings may cause product malfunction, property damage, serious bodily injury and/or death, and void your warranty.
5. Products that are manufactured using spring steel components shall be used only in a non-corrosive indoor environment.
6. All pipe supports, hangers, intermediate components and structural attachments must **ONLY** be used as described herein and are NEVER to be used for any other purpose.

NOTE: All load ratings are for static conditions and do not account for dynamic loading such as wind, water or seismic loads, unless otherwise noted.

The customer is responsible for:

- a. Conformance to all governing codes.
- b. The integrity of structures to which the products are attached, including their capability of safely accepting the loads imposed, as evaluated by a qualified engineer.
- c. Using appropriate industry standard hardware as noted above.

SAFETY INSTRUCTIONS:

All governing codes and regulations and those required by the job site must be observed. Always use appropriate safety equipment such as eye protection, hard hat, and gloves as appropriate to the application.



Pentair, CADDY, ERICO CADWELD, ERICO CRITEC, ERICO, ERIFLEX, and LENTON are owned by Pentair or its global affiliates. All other trademarks are the property of their respective owners. Pentair reserves the right to change specifications without prior notice.



Parallel to Stud and up to 1/8" Flange
(Metal and wood studs)



Figure 1

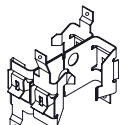
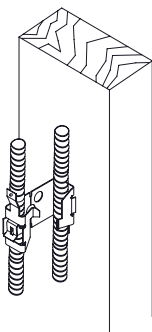
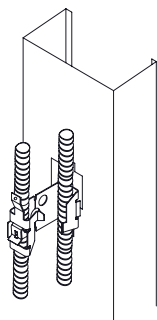
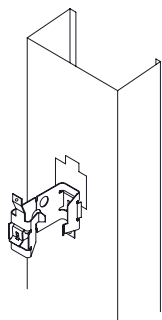
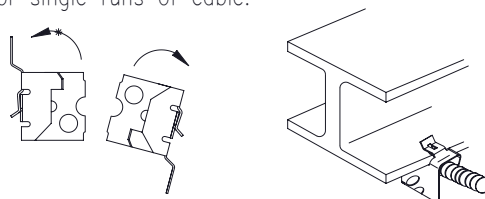

Figure 2



Flange Application

MAC2 snaps in half making 2 fasteners for single runs of cable!



Part Number	Figure	Application
MAC2	1	Metal or wood stud and 1/4" [6] flange
MAC2T	2	1 to 4 runs of MC/AC to metal stud

1. Snap clip onto metal stud or screw clip to wood stud
2. Press MC/AC cable into clip

Tee Grid

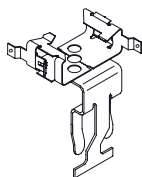
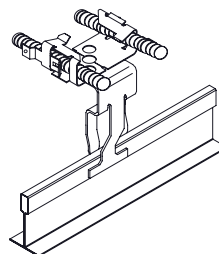
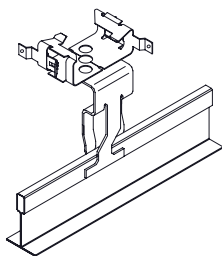

Figure 3



1. Place inverted "T" tab against acoustical tee bar
2. Push curved tabs back over on opposite side of tee bar and push down
3. Press MC/AC cable into clip
4. Note: An independent support is needed to meet code

Part Number	Figure	Application
MAC2ATA	3	1 or 2 runs of MC/AC to acoustical tee bar

Beam Clamp

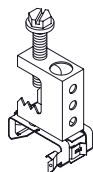
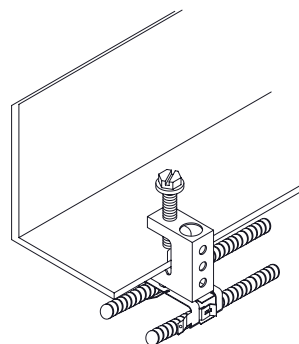
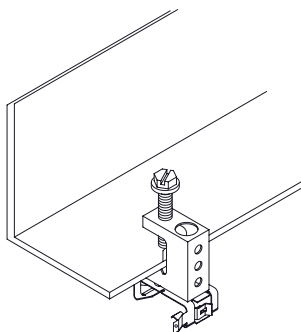

Figure 4



1. Place on beam and tighten screw securely. (Approx. 20 in-lbs torque)
2. Press MC/AC cable into clip

Part Number	Figure	Application
MAC2BC	4	1 or 2 runs of MC/AC to 1/8" [3] through 1/2" [13] flange



Pentair, CADDY, ERICO CADWELD, ERICO CRITEC, ERICO, ERIFLEX, and LENTON are owned by Pentair or its global affiliates. All other trademarks are the property of their respective owners. Pentair reserves the right to change specifications without prior notice.

Side Mount Flange Clips

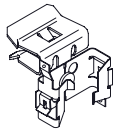
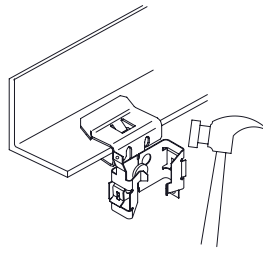
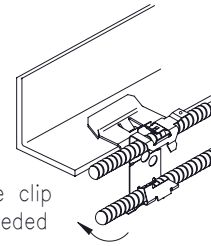

Figure 5



1. Using hammer, tap clamp onto flange



Rotate clip as needed

2. Twist clip into required orientation
3. Press MC/AC cable into clip

Part Number	Figure	Application
MAC224SM	5	1 or 2 runs of MC/AC to 1/8" [3] through 1/4" [6] flange
MAC258SM		1 or 2 runs of MC/AC to 5/16" [8] through 1/2" [13] flange
MAC2912SM		1 or 2 runs of MC/AC to 1/2" [13] through 3/4" [19] flange

C and Z Purlin

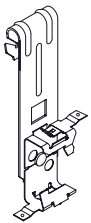

Figure 6

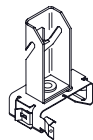
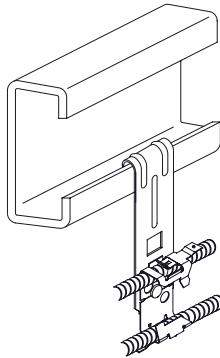
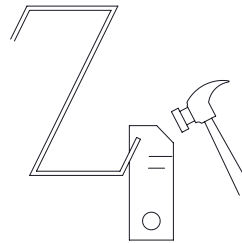
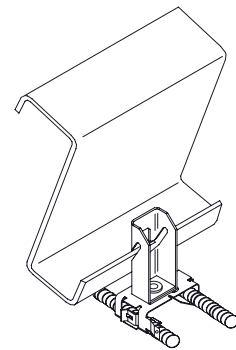

Figure 7



1. Press fastener against flange, tap straight down (1/16" to 1/4" flange or C purlin)
2. Press MC/AC cable into clip



Part Number	Figure	Application
MAC2VF14	6	1 or 2 runs of MC/AC to 1/16" [2] through 1/4" [6] C purlin or vertical flange
MAC2123	7	1 or 2 runs of MC/AC to Z purlin

Offset Bracket

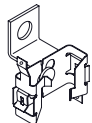
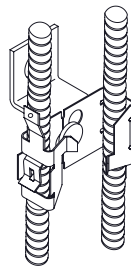
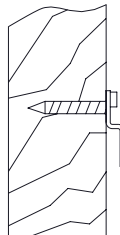

Figure 8



1. Nail or screw clip to structure
2. Press MC/AC cable into clip

Part Number	Figure	Application
MAC2AO	8	Offset bracket for 1 or 2 runs of MC/AC cable



Bottom Mount Flange Clips

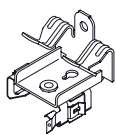
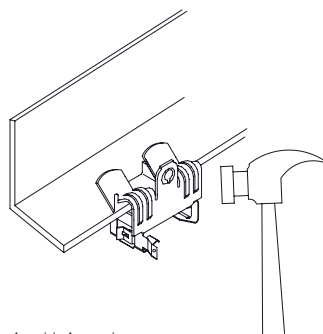
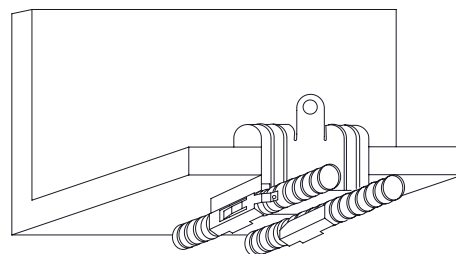

Figure 9



1. Using hammer, tap clamp onto flange



2. Press MC/AC Cable into clip

Part Number	Figure	Application
MAC224	9	1 or 2 runs MC/AC to 1/8" [3] through 1/4" [6] flange - bottom mount, rotates 360°
MAC258		1 or 2 runs MC/AC to 5/16" [8] through 1/2" [13] flange - bottom mount, rotates 360°
MAC2912		1 or 2 runs MC/AC to 1/2" [13] through 3/4" [19] flange - bottom mount, rotates 360°
MAC21318		1 or 2 runs MC/AC to 13/16" [21] through 1-1/8" [28] flange - bottom mount, rotates 360°

Drop Wires, Rods and Flanges

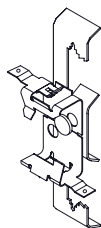
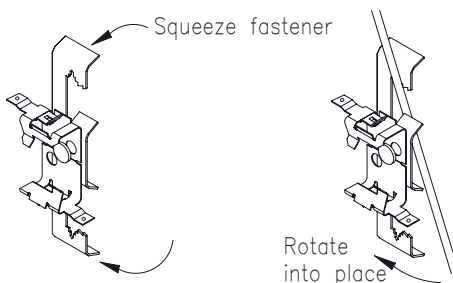
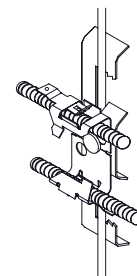

Figure 10



1. Squeeze fastener
2. Connect top edge over wire
3. Rotate into place
4. Release



5. Press MC/AC cable into clip

Part Number	Figure	Application
MAC24Z34	10	#12 through 1/4" [6] wire, plain or threaded rod and 1/8" [3] through 3/8" [10] flange for 1 or 2 runs of MC/AC
MAC26Z34		3/8" [10] plain or threaded rod and 3/8" [10] through 9/16" [14] flange for 1 or 2 runs of MC/AC

Through Metal Stud

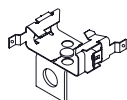
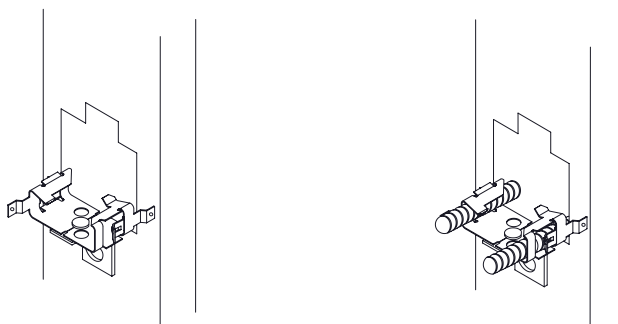

Figure 11



1. Screw clip to metal stud at passage way
2. Press MC/AC cable into clip

Part Number	Figure	Application
MAC2FB	11	1 or 2 runs of MC/AC through metal stud



Pentair, CADDY, ERICO CADWELD, ERICO CRITEC, ERICO, ERIFLEX, and LENTON are owned by Pentair or its global affiliates. All other trademarks are the property of their respective owners. Pentair reserves the right to change specifications without prior notice.