

Product data sheet

Characteristics

QO48M30DSGP

Generator panel, QO, 1 phase, 4 spaces, 8 circuits, 30A main breaker with interlock, NEMA1, surface cover door, UL



Main

Marketing Trade Name	QO
Product Type	Panel
Cover Type	Surface cover with door

Complementary

Tightening Torque	Cover 20 lb.in
Load Center Type	Main breaker
Rated Current	30 A
Number of Spaces	4
Max Short Circuit Current Rating	10 kA
Maximum Number of Single Pole Circuits	8
Maximum Number of Tandem Breakers	4
Number of Phases	1 phase
Wire Size	AWG 14...AWG 8 aluminium/copper
Ground Bar	Grounding bar (ordered separately)
Electrical Connection	Lugs
Wiring Configuration	3-wire
Busbar Material	Tin plated aluminium busbar
Enclosure Material	Welded sheet steel
Surface Finish	Baked enamel Gray
Box Number	4
Height	12.56 in (319 mm)
Width	8.90 in (226 mm)

Environment

Enclosure Rating	NEMA 1 indoor
Ambient Air Temperature for Operation	23 °F (-5 °C) 104 °F (40 °C)
Product Certifications	UL Listed

Ordering and shipping details

Category	00101 - QO 1PH LC,2-8CKT,NEMA 1,3R
Discount Schedule	DE3A
GTIN	00785901868200
Nbr. of units in pkg.	1
Package weight(Lbs)	9.45 lb(US) (4.29 kg)
Returnability	Yes
Country of origin	MX

Packing Units

Package 1 Height	4.40 in (11.176 cm)
Package 1 width	10.70 in (27.178 cm)
Package 1 Length	14.40 in (36.576 cm)

Offer Sustainability

California proposition 65	WARNING: This product can expose you to chemicals including: Lead and lead compounds, which is known to the State of California to cause cancer and birth defects or other reproductive harm. For more information go to www.P65Warnings.ca.gov
REACH Regulation	REACH Declaration
REACH free of SVHC	Yes
EU RoHS Directive	Compliant EU RoHS Declaration
Toxic heavy metal free	Yes
Mercury free	Yes
RoHS exemption information	Yes
China RoHS Regulation	China RoHS Declaration

Contractual warranty

Warranty	18 months
----------	-----------

Approximate Dimensions

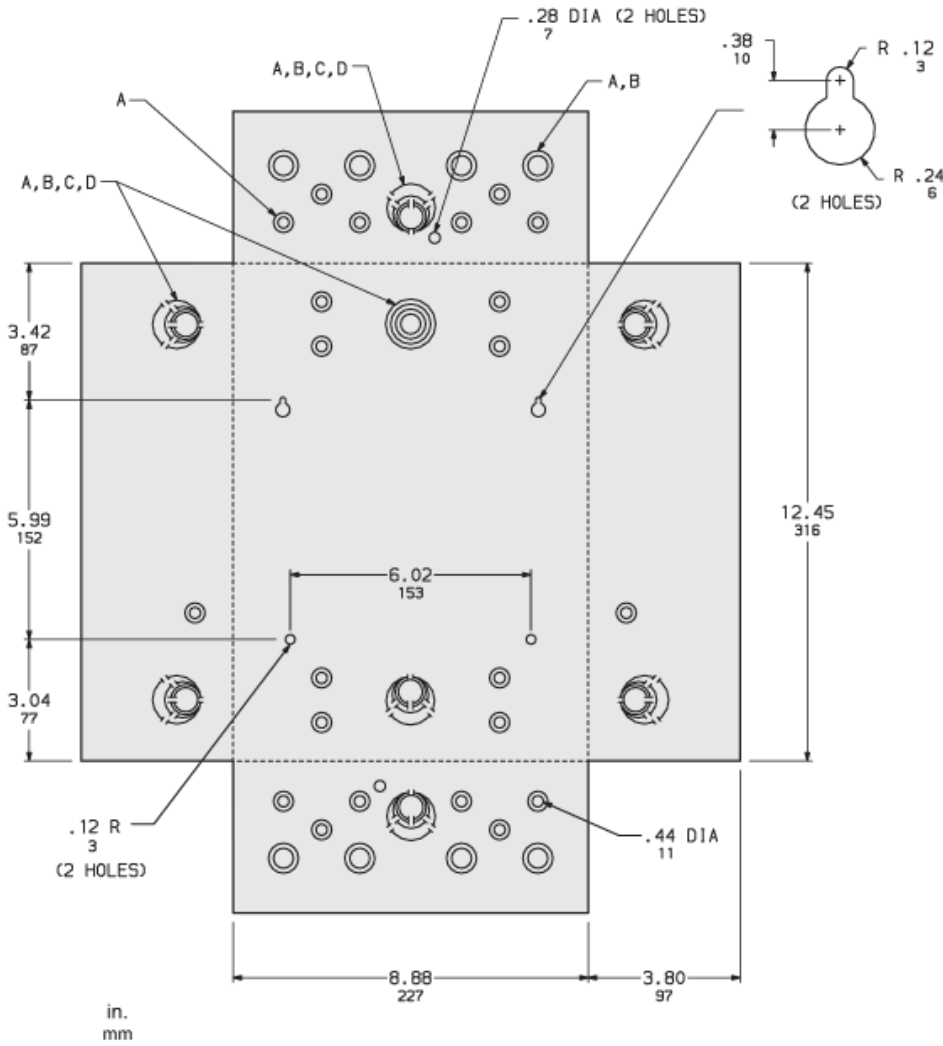

KNOCKOUTS				
SYMBOL	A	B	C	D
IN	.50	.75	1.00	1.25
MM	13	19	25	32

Connections and Wiring Diagrams

