



Main

Marketing Trade Name	QO
Product	Load Center
Enclosure type	Weatherproof enclosure
Cover type	Surface cover

Complementary

Tightening torque	Main lugs 35 lb.in, AWG 14...AWG 10, aluminium/copper Main lugs 45 lb.in, AWG 3, aluminium/copper Main lugs 40 lb.in, AWG 8...AWG 4, aluminium/copper Main lugs 35 lb.in, AWG 12...AWG10, aluminium/copper
Load Center Type	Main lugs
Line Rated Current	70 A
Number of spaces	2
Max Short Circuit Current Rating	65 kA
Maximum Number of Single Pole Circuits	4
Maximum Number of Tandem Breakers	2
Number of Phases	1 phase
Voltage Rating	120/240 V AC
Wire Size	AWG 12...AWG 3 aluminium AWG 14...AWG 4 copper
Electrical Connection	Lugs
Grounding Bar	Grounding bar (ordered separately)
Electrical connection	Lugs
Wiring configuration	3-wire
Busbar Material	Tin plated aluminium busbar
Enclosure Material	Welded galvanized steel
Cover Finish	Baked enamel Gray
Box number	1R
Maximum Height	9.37 in (238 mm)
Maximum Width	4.88 in (124 mm)

Environment

Enclosure Rating	NEMA 3R outdoor
Ambient air temperature for operation	23 °F (-5 °C) 104 °F (40 °C)
Product certifications	UL Listed

The information provided in this documentation contains general descriptions and/or technical characteristics of the performance of the products contained herein. This documentation is not intended as a substitute for and is not to be used for determining suitability or reliability of these products for specific user applications. It is the duty of any such user or integrator to perform the appropriate and complete risk analysis, evaluation and testing of the products with respect to the relevant specific application or use thereof. Neither Schneider Electric Industries SAS nor any of its affiliates or subsidiaries shall be responsible or liable for misuse of the information contained herein.

Ordering and shipping details

Category	00101 - QO 1PH LC,2-8CKT,NEMA 1,3R
Discount Schedule	DE3A
GTIN	00785901785132
Nbr. of units in pkg.	1
Package weight(Lbs)	5.05 lb(US) (2.29 kg)
Returnability	Yes
Country of origin	MX

Packing Units

Unit Type of Package 1	PCE
Package 1 Height	4.80 in (12.192 cm)
Package 1 width	5.80 in (14.732 cm)
Package 1 Length	11.00 in (27.94 cm)
Unit Type of Package 2	PAL
Number of Units in Package 2	213
Package 2 Weight	1127.00 lb(US) (511.198 kg)
Package 2 Height	37.50 in (95.25 cm)
Package 2 width	40.00 in (101.6 cm)
Package 2 Length	48.00 in (121.92 cm)

Offer Sustainability

Sustainable offer status	Green Premium product
REACH free of SVHC	Yes
EU RoHS Directive	Compliant EU RoHS Declaration
Toxic heavy metal free	Yes
Mercury free	Yes
RoHS exemption information	Yes
China RoHS Regulation	China RoHS Declaration
Environmental Disclosure	Product Environmental Profile

Contractual warranty

Warranty	18 months
----------	-----------

Approximate Dimensions

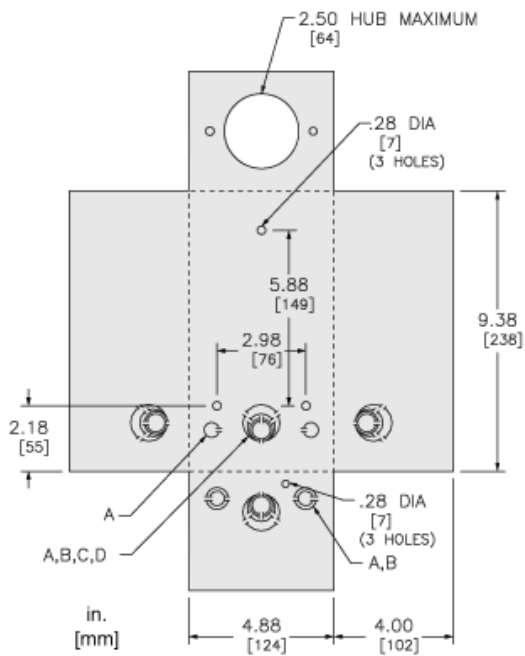

KNOCKOUTS				
SYMBOL	A	B	C	D
IN	.50	.75	1.00	1.25
MM	13	19	25	32

