

# TECHNICAL SPECIFICATIONS

## S-32

**MODEL NUMBER 141021**

DIMENSIONS: 32" x 32" x 72" Gelcoat



### STANDARD FEATURES

- One-piece gelcoated fiberglass shower
- Built-in corner shelves
- Center drain
- Textured floor

### UNIQUE FEATURES

- None

### OPTIONS

- Lifter for Pivolok Doors

### SYSTEMS

- None

### DOOR SELECTION

Combine with AKER's complete shower door offering visit [www.akerbymax.com](http://www.akerbymax.com)

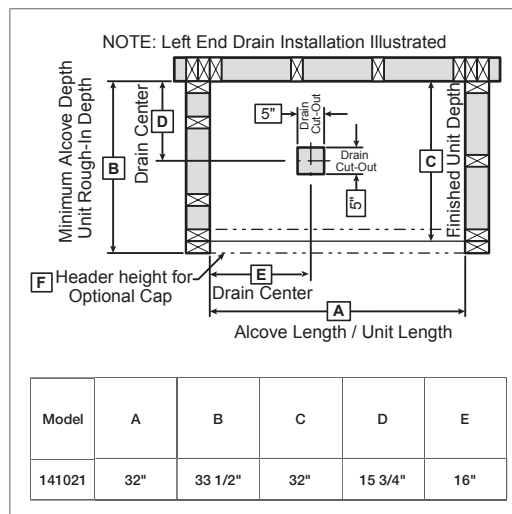
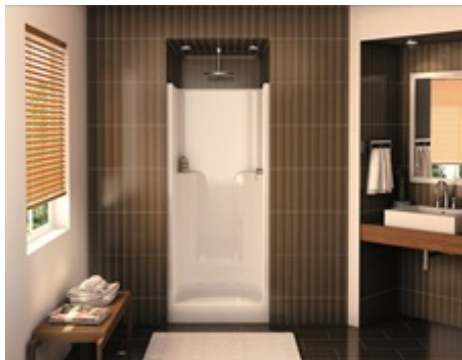

Project : .....

Contractor : .....

AKER Representative : ..... Tel : .....

Date : .....

### CERTIFICATIONS

AKER products adhere to one or more of the following certifications:



# TECHNICAL SPECIFICATIONS

## S-32

MODEL NUMBER 141021

### TECHNICAL DRAWINGS

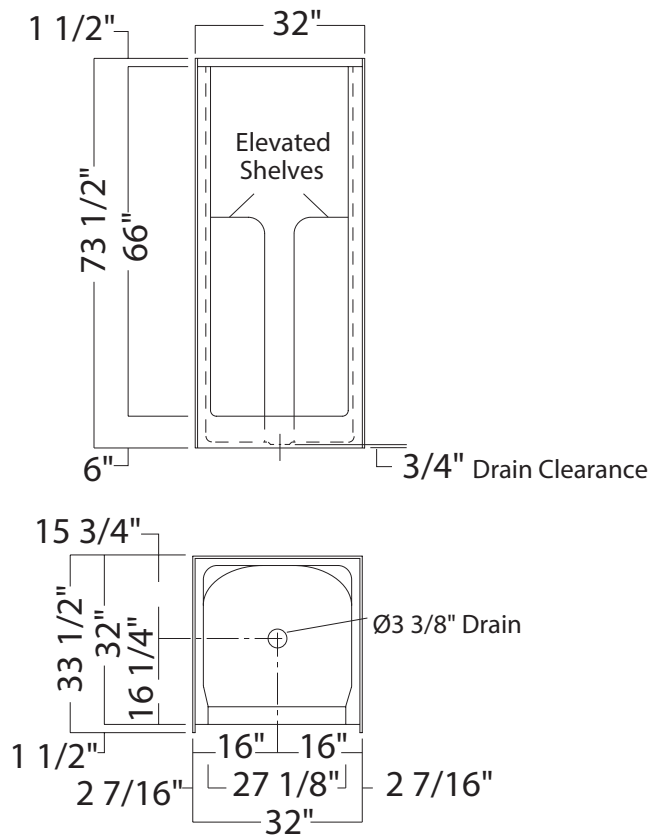

All dimensions are approximate. Structure measurements must be verified against the unit to ensure proper fit.