



LEVEL-FIT CLOSET FLANGE WITH PLASTIC RING TECHNICAL SPECIFICATION

Job Name _____	Item # _____
Location _____	
Engineer _____	Contractor _____
PO # _____	Tag _____
Representative _____	

SPECIFICATIONS

Oatey Level Fit Closet Flanges are designed to connect a water closet outlet to a plumbing system and sit flush with the floor. Oatey 3" or 4" Level Fit Closet Flanges solvent weld over 3" or inside 4" Sch. 40 DWV Pipe. 3" Inside Fit Closet Flange solvent welds inside 3" Schedule 40 DWV pipe

DESCRIPTION

- Flange with four mounting slots
- Four countersunk screw holes provide secure attachment to floor
- Flange sits flush on floor
- Available with molded-in test cap

APPROVALS & LISTINGS

PVC Compliance Listing	IAPMO Listing File #2896 Markings:UPC, cUPC, ASTM D 2665
ABS Compliance Listing	IAPMO Listing File # 3905 Markings: UPC, cUPC, ASTM D 2661



*UPC Does not apply to Inside Fit.

PHYSICAL PROPERTIES

ABS Plastic	Black
PVC Plastic	White

PRODUCT SELECTOR

LEVEL FIT CLOSET FLANGE			
✓	Product Number	Description	Pack
	43502	3" or 4" ABS Closet Flange w/out Test Cap	12
	43503	3" or 4" PVC Closet Flange w/out Test Cap	12
	43504	3" or 4" ABS Closet Flange w/ Test Cap	12
	43505	3" or 4" PVC Closet Flange w/ Test Cap	12
INSIDE FIT CLOSET FLANGE*			
	43506	3" ABS Inside Fit Closet Flange w/ Test Cap	12
	43507	3" PVC Inside Fit Closet Flange w/ Test Cap	12
	43508	3" ABS Inside Fit Closet Flange w/out Test Cap	12
	43509	3" PVC Inside Fit Closet Flange w/out Test Cap	12



3 OR 4" LEVEL FIT CLOSET FLANGE DIMENSIONS

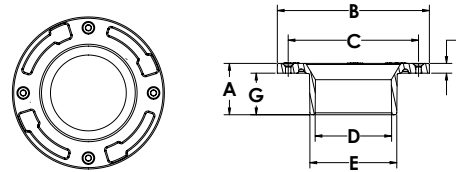

3" INSIDE FIT LEVEL FIT CLOSET FLANGE DIMENSIONS

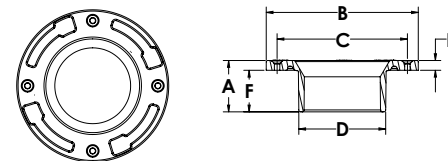

DIMENSIONS

3 OR 4" LEVEL FIT CLOSET FLANGE DIMENSIONS					
[A]:	Overall Height	2.36"	[E]:	Hub O.D.	4.00"
[B]:	Overall Diameter	7.00"	[F]:	Flange Ring Thickness	0.45"
[C]:	Screw Centers	6.00"	[G]:	Hub Depth	1.91"
[D]:	Hub I.D.	3.52"			

3" INSIDE FIT LEVEL FIT CLOSET FLANGE DIMENSIONS					
[A]:	Overall Height	2.05"	[D]:	Hub O.D.	3.03"
[B]:	Overall Diameter	7.00"	[E]:	Flange Ring Thickness	0.45"
[C]:	Screw Centers	6.00"	[F]:	Hub Depth	1.60"

Access BIM/Revit content through www.oatey.com