

Powder Actuated Fastening Systems

FASTENING INNOVATIONS



P1000

- LIGHT DUTY**
- .22 Caliber
 - Single Shot
 - Hammer Actuated

Hammer actuated, general purpose powder actuated tool. Designed for high reliability, low maintenance and economy. This tool uses four levels of power; grey through yellow loads (levels 1-4) and .300, 8mm head fasteners with lengths of 1/2" through 3".

APPLICATIONS

- 1 x 2 to Block Wall
- 2 x 4 to Block Wall
- 2 x 4 to Concrete Slab
- Electrical Fixture to Concrete

- **POWERFUL...** One blow sets pin flush.
- **COMFORTABLE...** Ergonomically designed soft handle.
- **FAST...** No pre-drilling or hole spotting.
- **QUIETER, FASTER and LESS RECOIL** than many other powder actuated tools.
- **GREAT TOOL** for DIY market and small contractors.



Blister Pack
Clamshell Packaging Cat. No. 52013

LOADS



.22 CALIBER "A" LOW VELOCITY LOADS FOR POWERS P1,000, P2201, P7201, RAMSET® 721 AND M70, HILTI® DXE37 AND DXE72

CAT. NO.	DESCRIPTION	STD. BOX	STD. CTN.	MASTER CTN.
50500	Gray, .22A	100	5,000	20,000
50502	Brown, .22A	100	5,000	20,000
50504	Green, .22A	100	5,000	20,000
50506	Yellow, .22A	100	5,000	20,000

PINS



DRIVE PIN SIZES (ALSO REFERENCE 8MM DRIVE PINS, SPECIALTY PINS & ASSEMBLIES STARTING ON PAGE 15)

.300 HEAD DIAMETER DRIVE PINS					.300 DIAMETER HEAD DRIVE PINS WITH TOP HAT					.300 HEAD DIAMETER DRIVE PINS WITH 7/8" WASHER				
CAT. NO.	SHANK LENGTH	SHANK DIA.	STD. BOX	STD. CTN.	CAT. NO.	SHANK LENGTH	SHANK DIA.	STD. BOX	STD. CTN.	CAT. NO.	SHANK LENGTH	SHANK DIA.	STD. BOX	STD. CTN.
50012	1/2" (K)	.145	100	5,000	50136	1/2" (K)	.145	100	5,000	50090	1"	.145	100	1,000
50016	5/8" (K)	.145	100	5,000	50138	5/8" (K)	.145	100	5,000	50092	1-1/4"	.145	100	1,000
50022	3/4"	.145	100	5,000	50140	3/4"	.145	100	5,000	50094	1-1/2"	.145	100	1,000
50026	1"	.145	100	5,000	50144	1"	.145	100	5,000	50096	2"	.145	100	1,000
50030	1-1/8"	.145	100	1,000	.300 HEAD DIAMETER DRIVE PINS - MASTER PACK					50098	2-1/2"	.145	100	1,000
50032	1-1/4"	.145	100	1,000	50980	1/2" (K)	.145	100	5,000	50100	3"	.145	100	1,000
50034	1-1/2"	.145	100	1,000	53300	5/8" (K)	.145	100	5,000	.300 HEAD DIAMETER DRIVE PINS WITH 1" WASHER				
50036	1-3/4"	.145	100	1,000	53400	5/8" (K) Top Hat	.145	100	5,000	50108	1-1/4"	.145	100	1,000
50038	2"	.145	100	1,000	51040	3/4"	.145	100	5,000	50110	1-1/2"	.145	100	1,000
50040	2-1/4"	.145	100	1,000	51100	1"	.145	100	5,000	50112	2"	.145	100	1,000
50042	2-3/8"	.145	100	1,000	51160	1-1/4"	.145	100	5,000	50114	2-1/2"	.145	100	1,000
50044	2-1/2"	.145	100	1,000	51340	1/2" (K) Top Hat	.145	100	5,000	50116	3"	.145	100	1,000
50046	2-3/4"	.145	100	1,000	51400	3/4" Top Hat	.145	100	5,000	.300 HEAD DIAMETER DRIVE PINS WITH 1-7/16" INSULATION WASHER				
50048	3"	.145	100	1,000	51520	1" Top Hat	.145	100	5,000	50122	1-1/2"	.145	100	1,000
.300 HEAD DIAMETER STEP SHANK PINS					.300 HEAD DIAMETER DRIVE PINS WITH 3/4" WASHER					50126	2-1/2"	.145	50	500
50158	3/4" Step Shank	.145/.130	100	1,000	50070	3/4"	.145	100	1,000					
50159	1" Step Shank	.145/.130	100	1,000	50080	2-1/2"	.145	100	1,000					
(K) - knurled					50082	3"	.145	100	1,000					
					(K) - knurled									



LIGHT DUTY

- .22 Caliber
- Single Shot
- 3" Pin Capacity

P2201

The P2201 is a low velocity, single shot, .22 caliber tool which can be used to install .300 head drive pins, 8mm head drive pins and 1/4"-20 threaded studs, up to 3" in total length. The P2201 is designed for maintenance or residential contractors.

APPLICATIONS

- Conduit Clip to Concrete
- Track to Floor
- Electrical Fixture to Concrete
- Electrical Fixture to Steel
- Wood to Concrete
- Wood to Steel
- Residential Construction

Blister Pack



Clamshell Packaging Cat. No. 52007

TOOL KIT INCLUDES

- Safety Glasses, Disposable Ear Plugs
 - Allen Wrenches, Wire Brushes, Tool Lubricant
 - Spall Guard
 - Pin Starter Kit
- † .300 Headed Pins: (50) 1/2", (50) 3/4", (15) 3" with 7/8" washer

REPLACEMENT PARTS (1 EACH)

Can be ordered separately

- 52522 Piston
- 52510 Nose Piece
- 52512 Piston Reset Pin

For additional spare parts please reference the tool manual or Powers' Buyers Guide.



Tool Kit Cat. No. 52006

LOADS



.22 CALIBER "A" LOW VELOCITY LOADS FOR POWERS P1,000, P2201, P7201, RAMSET® 721 AND M70, HILTI® DXE37 AND DXE72

CAT. NO.	DESCRIPTION	STD. BOX	STD. CTN.	MASTER CTN
50500	Gray, .22A	100	5,000	20,000
50502	Brown, .22A	100	5,000	20,000
50504	Green, .22A	100	5,000	20,000
50506	Yellow, .22A	100	5,000	20,000

PINS

DRIVE PIN SIZES (ALSO REFERENCE 8MM DRIVE PINS, SPECIALTY PINS & ASSEMBLIES STARTING ON PAGE 15)

.300 HEAD DIAMETER DRIVE PINS					.300 DIAMETER HEAD DRIVE PINS WITH TOP HAT					.300 HEAD DIAMETER DRIVE PINS WITH 7/8" WASHER				
CAT. NO.	SHANK LENGTH	SHANK DIA.	STD. BOX	STD. CTN.	CAT. NO.	SHANK LENGTH	SHANK DIA.	STD. BOX	STD. CTN.	CAT. NO.	SHANK LENGTH	SHANK DIA.	STD. BOX	STD. CTN.
50012	1/2" (K)	.145	100	5,000	50136	1/2" (K)	.145	100	5,000	50090	1"	.145	100	1,000
50016	5/8" (K)	.145	100	5,000	50138	5/8" (K)	.145	100	5,000	50092	1-1/4"	.145	100	1,000
50022	3/4"	.145	100	5,000	50140	3/4"	.145	100	5,000	50094	1-1/2"	.145	100	1,000
50026	1"	.145	100	5,000	50144	1"	.145	100	5,000	50096	2"	.145	100	1,000
50030	1-1/8"	.145	100	1,000						50098	2-1/2"	.145	100	1,000
50032	1-1/4"	.145	100	1,000						50100	3"	.145	100	1,000
50034	1-1/2"	.145	100	1,000										
50036	1-3/4"	.145	100	1,000										
50038	2"	.145	100	1,000										
50040	2-1/4"	.145	100	1,000										
50042	2-3/8"	.145	100	1,000										
50044	2-1/2"	.145	100	1,000										
50046	2-3/4"	.145	100	1,000										
50048	3"	.145	100	1,000										
.300 HEAD DIAMETER STEP SHANK PINS					.300 HEAD DIAMETER DRIVE PINS WITH 3/4" WASHER					.300 HEAD DIAMETER DRIVE PINS WITH 1" WASHER				
50158	3/4" Step Shank	.145/.130	100	1,000	50070	3/4"	.145	100	1,000	50108	1-1/4"	.145	100	1,000
50159	1" Step Shank	.145/.130	100	1,000	50080	2-1/2"	.145	100	1,000	50110	1-1/2"	.145	100	1,000
					50082	3"	.145	100	1,000	50112	2"	.145	100	1,000
										50114	2-1/2"	.145	100	1,000
										50116	3"	.145	100	1,000
.300 HEAD DIAMETER DRIVE PINS WITH 1-7/16" INSULATION WASHER														
										50122	1-1/2"	.145	100	1,000
										50126	2-1/2"	.145	50	500

(K) - knurled

(K) - knurled



MEDIUM DUTY

- .22 Caliber
- Single Shot
- 1-1/2" Pin Capacity

P7201

The P7201 is a low velocity, single shot .22 caliber tool which can be used to install .300" head drive pins, 8mm head drive pins and 1/4"-20 threaded studs up to 1-1/2" in total length. The P7201 is commonly used in the drywall trade, and designed for repetitive use.

APPLICATIONS

- Conduit Clip to Concrete
- Track to Floor
- Electrical Fixture to Steel
- Wood to Concrete
- Wood to Steel
- Electrical Fixture to Concrete

Blister Pack



Clamshell Packaging Cat. No. 52005

TOOL KIT INCLUDES

- Safety Glasses, Disposable Ear Plugs
- Allen Wrenches, Wire Brushes, Tool Lubricant
- Spall Guard
- Pin Starter Kit
 - † .300 Headed Pins: (50) 1/2", (50) 3/4", (15) 3" with 7/8" washer



Tool Kit Cat. No. 52004

REPLACEMENT PARTS (1 EACH)

Can be ordered separately

- 52300 Piston
- 52306 Nose Piece
- 52308 Piston Reset Pin

For additional spare parts please reference the tool manual or Powers' Buyers Guide.

LOADS



.22 CALIBER "A" LOW VELOCITY LOADS FOR POWERS P1,000, P2201, P7201, RAMSET® 721 AND M70, HILTI® DXE37 AND DXE72

CAT. NO.	DESCRIPTION	STD. BOX	STD. CTN.	MASTER CTN.
50500	Gray, .22A	100	5,000	20,000
50502	Brown, .22A	100	5,000	20,000
50504	Green, .22A	100	5,000	20,000
50506	Yellow, .22A	100	5,000	20,000

PINS



DRIVE PIN SIZES (ALSO REFERENCE 8MM DRIVE PINS, SPECIALTY PINS & ASSEMBLIES STARTING ON PAGE 15)

.300 HEAD DIAMETER DRIVE PINS					.300 DIAMETER HEAD DRIVE PINS WITH TOP HAT					.300 HEAD DIAMETER DRIVE PINS WITH 3/4" WASHER				
CAT. NO.	SHANK LENGTH	SHANK DIA.	STD. BOX	STD. CTN.	CAT. NO.	SHANK LENGTH	SHANK DIA.	STD. BOX	STD. CTN.	CAT. NO.	SHANK LENGTH	SHANK DIA.	STD. BOX	STD. CTN.
50012	1/2" (K)	.145	100	5,000	50136	1/2" (K)	.145	100	5,000	50070	3/4"	.145	100	1,000
50016	5/8" (K)	.145	100	5,000	50138	5/8" (K)	.145	100	5,000	.300 HEAD DIAMETER DRIVE PINS WITH 7/8" WASHER				
50022	3/4"	.145	100	5,000	50140	3/4"	.145	100	5,000	50090	1"	.145	100	1,000
50026	1"	.145	100	5,000	50144	1"	.145	100	5,000	50092	1-1/4"	.145	100	1,000
50030	1-1/8"	.145	100	1,000	.300 HEAD DIAMETER DRIVE PINS - MASTER PACK					50094	1-1/2"	.145	100	1,000
50032	1-1/4"	.145	100	1,000	50980	1/2" (K)	.145	100	5,000	.300 HEAD DIAMETER DRIVE PINS WITH 1" WASHER				
50034	1-1/2"	.145	100	1,000	53300	5/8" (K)	.145	100	5,000	50108	1-1/4"	.145	100	1,000
50036	1-3/4"	.145	100	1,000	53400	5/8" (K) Top Hat	.145	100	5,000	50110	1-1/2"	.145	100	1,000
.300 HEAD DIAMETER STEP SHANK PINS					51040	3/4"	.145	100	5,000	.300 HEAD DIAMETER DRIVE PINS WITH 1-7/16" INSULATION WASHER				
50158	3/4" Step Shank	.145/.130	100	1,000	51100	1"	.145	100	5,000	50122	1-1/2"	.145	100	1,000
50159	1" Step Shank	.145/.130	100	1,000	51160	1-1/4"	.145	100	5,000					
(K) - knurled					51340	1/2" (K) Top Hat	.145	100	5,000					
					51400	3/4" Top Hat	.145	100	5,000					
					51520	1" Top Hat	.145	100	5,000					
					(K) - knurled									



MEDIUM DUTY

- .25 Caliber
- 10 Load Strip
- 1-1/2" Pin Capacity

P35s

The P35s is specially designed for acoustical and drywall contractors. It is a low velocity, semi-automatic tool which can be used to install .300 head drive pins, 8mm head drive pins and 1/4"-20 threaded studs up to 1-1/2" in total length. The P35s is designed for high speed and repetitive volume applications. The standard version of the tool is supplied with a flat end piston and a full size baseplate/guide. A limited access baseplate/guide assembly is also available.

APPLICATIONS

- Conduit Clip to Concrete
- Track to Floor
- Electrical Fixture to Concrete
- Electrical Fixture to Steel
- Wood to Concrete
- Wood to Steel
- Commercial Construction
- Reliable and Compact for Short Pin Applications

Tool Kit Cat. No. 52002
 Limited Access Tool Kit
 Cat. No. 52003



Clamshell Packaging Cat. No. 52023



TOOL KIT INCLUDES

- Safety Glasses, Disposable Ear Plugs
- Allen Wrenches, Wire Brushes, Tool Lubricant
- Spall Guard, Spare Parts
- Pin Starter Kit
 - † .300 Headed Pins: (50) 1/2", (50) 3/4", (50) 1-1/2"

REPLACEMENT PARTS (1 EACH)

Can be ordered separately

- 52200 Piston Standard 21/SDF
- 52204 Guide 21/F3-1 Baseplate 21/S1
- 52206 Baseplate 21/S1

For additional spare parts please reference the tool manual or Powers' Buyers Guide.



PINS

DRIVE PIN SIZES (ALSO REFERENCE 8MM DRIVE PINS, SPECIALTY PINS & ASSEMBLIES STARTING ON PAGE 15)

.300 HEAD DIAMETER DRIVE PINS					.300 DIAMETER HEAD DRIVE PINS WITH TOP HAT					.300 HEAD DIAMETER DRIVE PINS WITH 3/4" WASHER				
CAT. NO.	SHANK LENGTH	SHANK DIA.	STD. BOX	STD. CTN.	CAT. NO.	SHANK LENGTH	SHANK DIA.	STD. BOX	STD. CTN.	CAT. NO.	SHANK LENGTH	SHANK DIA.	STD. BOX	STD. CTN.
50012	1/2" (K)	.145	100	5,000	50136	1/2" (K)	.145	100	5,000	50070	3/4"	.145	100	1,000
50016	5/8" (K)	.145	100	5,000	50138	5/8" (K)	.145	100	5,000	.300 HEAD DIAMETER DRIVE PINS WITH 7/8" WASHER				
50022	3/4"	.145	100	5,000	50140	3/4"	.145	100	5,000	50090	1"	.145	100	1,000
50026	1"	.145	100	5,000	50144	1"	.145	100	5,000	50092	1-1/4"	.145	100	1,000
50030	1-1/8"	.145	100	1,000	.300 HEAD DIAMETER DRIVE PINS - MASTER PACK					50094	1-1/2"	.145	100	1,000
50032	1-1/4"	.145	100	1,000	50980	1/2" (K)	.145	100	5,000	.300 HEAD DIAMETER DRIVE PINS WITH 1" WASHER				
50034	1-1/2"	.145	100	1,000	53300	5/8" (K)	.145	100	5,000	50108	1-1/4"	.145	100	1,000
50036	1-3/4"	.145	100	1,000	53400	5/8" (K) Top Hat	.145	100	5,000	50110	1-1/2"	.145	100	1,000
.300 HEAD DIAMETER STEP SHANK PINS					51040	3/4"	.145	100	5,000	.300 HEAD DIAMETER DRIVE PINS WITH 1-7/16" INSULATION WASHER				
50158	3/4" Step Shank	.145/.130	100	1,000	51100	1"	.145	100	5,000	50122	1-1/2"	.145	100	1,000
50159	1" Step Shank	.145/.130	100	1,000	51160	1-1/4"	.145	100	5,000					
					51340	1/2" (K) Top Hat	.145	100	5,000					
					51400	3/4" Top Hat	.145	100	5,000					
					51520	1" Top Hat	.145	100	5,000					

(K) - knurled

(K) - knurled

LOADS



.25 CALIBER 10 LOAD STRIPS FOR POWERS P35S AND HILTI® DX35

CAT. NO.	DESCRIPTION	STD. BOX	STD. CTN.	MASTER CTN.
50570	Green, .25 strip	100	1,000	20,000
50574	Yellow, .25 strip	100	1,000	20,000
50578	Red, .25 strip	100	1,000	20,000
.25 CALIBER 10 LOAD STRIPS - MASTER PACK				
50572	Green, .25 strip		1,000	20,000
50576	Yellow, .25 strip		1,000	20,000
50580	Red, .25 strip		1,000	20,000

ACCESSORIES

- 52041 6' Smacker Pole Tool (Universal Bump Tool)
- 50065 Standard 6' Pole Tool (Trigger Style)
- 50066 Standard 8' Pole Tool (Trigger Style)

P3500

HEAVY DUTY

- .27 Caliber
- 10 Load Strip
- 3" Pin Capacity

The P3500 is a low velocity, semi-automatic .27 caliber tool which can be used to install .300 head drive pins, 8mm head drive pins and 1/4"-20 threaded studs, up to 3" in total length. The P3500 is designed for high speed, durability and repetitive volume applications.

APPLICATIONS

- Conduit Clip to Concrete
- Wood to Concrete
- Wood to Steel
- Electrical Fixture to Concrete
- Electrical Fixture to Steel
- Concrete Forming
- Commercial / Residential Construction

Blister Pack



Clamshell Packaging Cat. No. 52001

LOADS



.27 CALIBER SAFETY STRIP® FOR POWERS P3500/ PA3500, PA351, RAMSET® SA270, VIPER, HILTI® DX350, DX351, DX36M, AND DX451

CAT. NO.	DESCRIPTION	STD. BOX	STD. CTN.
50620	Brown, .27 safety strip	100	1,000
50622	Green, .27 safety strip	100	1,000
50626	Yellow, .27 safety strip	100	1,000
50630	Red, .27 safety strip	100	1,000
.27 CALIBER 10 LOAD STRIPS - MASTER PACK			
50624	Green, .27 safety strip	1,000	10,000
50628	Yellow, .27 safety strip	1,000	10,000
50632	Red, .27 safety strip	1,000	10,000

Tool Kit Cat. No. 52000



TOOL KIT INCLUDES

- Safety Glasses, Disposable Ear Plugs
- Allen Wrenches, Wire Brushes, Tool Lubricant
- Spall Guard, Spare Parts
- Pin Starter Kit

† .300 Headed Pins:
(50) 1/2", (50) 3/4",
(15) 3" with 7/8" washer

REPLACEMENT PARTS (1 EA.)

Can be ordered separately

- 52106 Piston Ring
- 52108 Guide 2/F-3
- 52110 Base Plate 2/S-13

For additional spare parts please reference the tool manual or Powers' Buyers Guide.

ACCESSORIES

- 52041 6' Smacker Pole Tool (Universal Bump Tool)
- 50065 Standard 6' Pole Tool (Trigger Style)
- 50066 Standard 8' Pole Tool (Trigger Style)

PINS



DRIVE PIN SIZES (ALSO REFERENCE 8MM DRIVE PINS, SPECIALTY PINS & ASSEMBLIES STARTING ON PAGE 15)

.300 HEAD DIAMETER DRIVE PINS

CAT. NO.	SHANK LENGTH	SHANK DIA.	STD. BOX	STD. CTN.
50012	1/2" (K)	.145	100	5,000
50016	5/8" (K)	.145	100	5,000
50022	3/4"	.145	100	5,000
50026	1"	.145	100	5,000
50030	1-1/8"	.145	100	1,000
50032	1-1/4"	.145	100	1,000
50034	1-1/2"	.145	100	1,000
50036	1-3/4"	.145	100	1,000
50038	2"	.145	100	1,000
50040	2-1/4"	.145	100	1,000
50042	2-3/8"	.145	100	1,000
50044	2-1/2"	.145	100	1,000
50046	2-3/4"	.145	100	1,000
50048	3"	.145	100	1,000

.300 HEAD DIAMETER STEP SHANK PINS

50158	3/4" Step Shank	.145/.130	100	1,000
50159	1" Step Shank	.145/.130	100	1,000

(K) - knurled

.300 DIAMETER HEAD DRIVE PINS WITH TOP HAT

CAT. NO.	SHANK LENGTH	SHANK DIA.	STD. BOX	STD. CTN.
50136	1/2" (K)	.145	100	5,000
50138	5/8" (K)	.145	100	5,000
50140	3/4"	.145	100	5,000
50144	1"	.145	100	5,000
.300 HEAD DIAMETER DRIVE PINS - MASTER PACK				
50980	1/2" (K)	.145	100	5,000
53300	5/8" (K)	.145	100	5,000
53400	5/8" (K) Top Hat	.145	100	5,000
51040	3/4"	.145	100	5,000
51100	1"	.145	100	5,000
51160	1-1/4"	.145	100	5,000
51340	1/2" (K) Top Hat	.145	100	5,000
51400	3/4" Top Hat	.145	100	5,000
51520	1" Top Hat	.145	100	5,000

.300 HEAD DIAMETER DRIVE PINS WITH 3/4" WASHER

50070	3/4"	.145	100	1,000
50080	2-1/2"	.145	100	1,000
50082	3"	.145	100	1,000

(K) - knurled

.300 HEAD DIAMETER DRIVE PINS WITH 7/8" WASHER

CAT. NO.	SHANK LENGTH	SHANK DIA.	STD. BOX	STD. CTN.
50090	1"	.145	100	1,000
50092	1-1/4"	.145	100	1,000
50094	1-1/2"	.145	100	1,000
50096	2"	.145	100	1,000
50098	2-1/2"	.145	100	1,000
50100	3"	.145	100	1,000

.300 HEAD DIAMETER DRIVE PINS WITH 1" WASHER

50108	1-1/4"	.145	100	1,000
50110	1-1/2"	.145	100	1,000
50112	2"	.145	100	1,000
50114	2-1/2"	.145	100	1,000
50116	3"	.145	100	1,000

.300 HEAD DIAMETER DRIVE PINS WITH 1-7/16" INSULATION WASHER

50122	1-1/2"	.145	100	1,000
50126	2-1/2"	.145	50	500

PA3500

HEAVY DUTY POWER ADJUSTABLE

- .27 Caliber
- 10 Load Strip
- 3" Pin Capacity

The PA3500 is a modified version of the P3500 that includes a power adjuster, allowing the operator to effectively decrease the power level of the load being used by up to two (2) levels. Ex. A red load can be adjusted down to the level of a green load.

APPLICATIONS

- Conduit Clip to Concrete
- Wood to Concrete
- Wood to Steel
- Electrical Fixture to Concrete
- Electrical Fixture to Steel
- Concrete Forming
- Commercial / Residential Construction



Clamshell Packaging Cat. No. 52025

Tool Kit Cat. No. 52019



TOOL KIT INCLUDES

- Safety Glasses, Disposable Ear Plugs
- Allen Wrenches, Wire Brushes, Tool Lubricant
- Spall Guard, Spare Parts
- Pin Starter Kit
 - † .300 Headed Pins: (50) 1/2", (50) 3/4", (15) 3" with 7/8" washer

REPLACEMENT PARTS (1 EA.)

Can be ordered separately

- 52103 PA Piston Flat End with Ring
- 52108 Guide 2/F-3
- 52110 Base Plate 2/S-13

For additional spare parts please reference the tool manual or Powers' Buyers Guide.

ACCESSORIES

- 52041 6' Smacker Pole Tool (Universal Bump Tool)
- 50065 Standard 6' Pole Tool (Trigger Style)
- 50066 Standard 8' Pole Tool (Trigger Style)

LOADS



.27 CALIBER SAFETY STRIP® FOR POWERS P3500/PA3500, PA351, RAMSET® SA270, VIPER, HILTI® DX350, DX351, DX36M, AND DX451

CAT. NO.	DESCRIPTION	STD. BOX	STD. CTN.
50620	Brown, .27 safety strip	100	1,000
50622	Green, .27 safety strip	100	1,000
50626	Yellow, .27 safety strip	100	1,000
50630	Red, .27 safety strip	100	1,000
.27 CALIBER 10 LOAD STRIPS - MASTER PACK			
50624	Green, .27 safety strip	1,000	10,000
50628	Yellow, .27 safety strip	1,000	10,000
50632	Red, .27 safety strip	1,000	10,000

PINS



DRIVE PIN SIZES (ALSO REFERENCE 8MM DRIVE PINS, SPECIALTY PINS & ASSEMBLIES STARTING ON PAGE 15)

.300 HEAD DIAMETER DRIVE PINS					.300 DIAMETER HEAD DRIVE PINS WITH TOP HAT					.300 HEAD DIAMETER DRIVE PINS WITH 7/8" WASHER				
CAT. NO.	SHANK LENGTH	SHANK DIA.	STD. BOX	STD. CTN.	CAT. NO.	SHANK LENGTH	SHANK DIA.	STD. BOX	STD. CTN.	CAT. NO.	SHANK LENGTH	SHANK DIA.	STD. BOX	STD. CTN.
50012	1/2" (K)	.145	100	5,000	50136	1/2" (K)	.145	100	5,000	50090	1"	.145	100	1,000
50016	5/8" (K)	.145	100	5,000	50138	5/8" (K)	.145	100	5,000	50092	1-1/4"	.145	100	1,000
50022	3/4"	.145	100	5,000	50140	3/4"	.145	100	5,000	50094	1-1/2"	.145	100	1,000
50026	1"	.145	100	5,000	50144	1"	.145	100	5,000	50096	2"	.145	100	1,000
50030	1-1/8"	.145	100	1,000	.300 HEAD DIAMETER DRIVE PINS - MASTER PACK					50098	2-1/2"	.145	100	1,000
50032	1-1/4"	.145	100	1,000	50980	1/2" (K)	.145	100	5,000	50100	3"	.145	100	1,000
50034	1-1/2"	.145	100	1,000	53300	5/8" (K)	.145	100	5,000	.300 HEAD DIAMETER DRIVE PINS WITH 1" WASHER				
50036	1-3/4"	.145	100	1,000	53400	5/8" (K) Top Hat	.145	100	5,000	50108	1-1/4"	.145	100	1,000
50038	2"	.145	100	1,000	51040	3/4"	.145	100	5,000	50110	1-1/2"	.145	100	1,000
50040	2-1/4"	.145	100	1,000	51100	1"	.145	100	5,000	50112	2"	.145	100	1,000
50042	2-3/8"	.145	100	1,000	51160	1-1/4"	.145	100	5,000	50114	2-1/2"	.145	100	1,000
50044	2-1/2"	.145	100	1,000	51340	1/2" (K) Top Hat	.145	100	5,000	50116	3"	.145	100	1,000
50046	2-3/4"	.145	100	1,000	51400	3/4" Top Hat	.145	100	5,000	.300 HEAD DIAMETER DRIVE PINS WITH 1-7/16" INSULATION WASHER				
50048	3"	.145	100	1,000	51520	1" Top Hat	.145	100	5,000	50122	1-1/2"	.145	100	1,000
.300 HEAD DIAMETER STEP SHANK PINS					.300 HEAD DIAMETER DRIVE PINS WITH 3/4" WASHER					50126	2-1/2"	.145	50	500
50158	3/4" Step Shank	.145/.130	100	1,000	50070	3/4"	.145	100	1,000					
50159	1" Step Shank	.145/.130	100	1,000	50080	2-1/2"	.145	100	1,000					
					50082	3"	.145	100	1,000					

(K) - knurled

(K) - knurled

P3801

Powerful and reliable heavy-duty powder actuated tool, for installing 3/8" threaded studs into concrete, steel and 10mm pins into concrete. This tool features an easy load ejector and has a low recoil for greater operator comfort. The P3801 is independent of any external power source saving you time and money.

APPLICATIONS

- Hanging Sprinkler Pipe
- Heavy Duty Applications for Steel and Concrete
- Electrical Fixtures
- Hard Concrete

HEAVY DUTY

- .27 Caliber • Single Shot
- 1/4" to 3/8" Threaded Studs, 10mm Head and 3/8" Headed Drive Pins

TOOL KIT INCLUDES

- Safety Glasses, Disposable Ear Plugs
- Allen Wrenches, Wire Brushes, Tool Lubricant
- Spall Guard, Spare Parts
- Pin Starter Kit
 - † Threaded Studs: (100) 1/4", (50) 3/8"
 - † .27 Caliber Long Loads: (100) Yellow, (100) Red, (100) Purple

REPLACEMENT PARTS (1 EACH)

Can be ordered separately

- 52400 P3801 Piston with Ring
- 52402 Nose Piece
- 52404 Base Plate

For additional spare parts please reference the tool manual or Powers' Buyers Guide.

ACCESSORIES

- 52041 6' Smacker Pole Tool (Universal Bump Tool)
- 50065 Standard 6' Pole Tool (Trigger Style)
- 50066 Standard 8' Pole Tool (Trigger Style)



Tool Kit Cat. No. 52008

LOADS



.27 CALIBER SINGLE LOADS FOR POWERS P3801, HILTI® DX400

CAT. NO.	DESCRIPTION	STD. BOX	STD. CTN.	MASTER CTN.
50588	Red, .27 single	100	5,000	20,000
50590	Purple, .27 single	100	5,000	20,000

.27 CALIBER LONG LOADS FOR POWERS P3801, RAMSET® MD380 AND HILTI® DX600N

CAT. NO.	DESCRIPTION	STD. BOX	STD. CTN.	MASTER CTN.
50608	Green, .27 long	100	2,500	10,000
50610	Yellow, .27 long	100	2,500	10,000
50612	Red, .27 long	100	2,500	10,000
50614	Purple, .27 long	100	2,500	10,000

PINS



10MM HEAD DRIVE PINS

CAT. NO.	SHANK LENGTH	HEAD DIA.	SHANK DIA.	STD. BOX	STD. CTN.
50850	27mm - 1"	10mm	.177	100	5,000
50852	32mm - 1-1/4"	10mm	.177	100	5,000
50854	42mm - 1-5/8"	10mm	.177	100	5,000
50856	52mm - 2"	10mm	.177	100	5,000
50858	62mm - 2-1/2"	10mm	.177	100	1,000
50860	72mm - 2-7/8"	10mm	.177	100	1,000
50862	82mm - 3-1/4"	10mm	.177	100	1,000



DRIVE PIN SIZES

3/8" HEAD DIAMETER DRIVE PINS					
CAT. NO.	SHANK LENGTH	SHANK DIA.	STD. BOX	STD. CTN.	
50162	1"	.171	100	1,000	
50164	1-1/4"	.171	100	1,000	
50166	1-1/2"	.171	100	1,000	
50170	2"	.171	100	1,000	
50172	2-1/2"	.171	100	1,000	
50174	3"	.171	100	1,000	
50176	3-1/8"	.216/.188	100	1,000	(w/step shank)

STUDS



THREADED STUDS SIZES

1/4" -20 THREADED STUDS					
CAT. NO.	THREAD LENGTH	SHANK LENGTH	SHANK DIA.	STD. BOX	STD. CTN.
50320	1/2"	1/2" (K)	.145	100	5,000
50322	3/4"	1/2" (K)	.145	100	1,000
50326	3/4"	3/4"	.145	100	1,000
50328	1/2"	1"	.145	100	1,000
50330	3/4"	1"	.145	100	1,000
50334	1/2"	1-1/4"	.145	100	1,000
50336	3/4"	1-1/4"	.145	100	1,000
3/8" -16 THREADED STUDS					
CAT. NO.	THREAD LENGTH	SHANK LENGTH	SHANK DIA.	STD. BOX	STD. CTN.
50340	1-1/4"	3/4" (K)	.205	100	1,000
50342	1-1/4"	1"	.205	100	1,000
50344	1-1/4"	1-1/4"	.205	100	1,000

(K) - knurled



**FULLY AUTOMATIC
POWER ADJUSTABLE**

- .27 Caliber
- 10 Fastener Magazine
- 1-5/8" Pin Capacity

PA351

Lightweight, heavy duty fully automatic powder actuated tool with 10 Pin strip fastener magazine for high volume applications. This tool fastens up to 700 nails per hour for increased productivity. Easy drop in magazine for one handed operation. A power adjuster provides variable load level choices and the tool automatically cycles the load.

APPLICATIONS

- Reliable and Compact for Short Pin Applications
- Commercial / Residential Construction
- Conduit Clip to Concrete
- Electrical Fixture to Concrete
- Electrical Fixture to Steel
- Wood to Concrete
- Wood to Steel
- Track to Floor

LOADS



.27 CALIBER SAFETY STRIP® FOR POWERS P3500/PA3500, PA351, RAMSET® SA270, VIPER, HILTI® DX350, DX351, DX36M, AND DX451

CAT. NO.	DESCRIPTION	STD. BOX	STD. CTN.
50620	Brown, .27 safety strip	100	1,000
50622	Green, .27 safety strip	100	1,000
50626	Yellow, .27 safety strip	100	1,000
50630	Red, .27 safety strip	100	1,000
.27 CALIBER 10 LOAD STRIPS - MASTER PACK			
50624	Green, .27 safety strip	1,000	10,000
50628	Yellow, .27 safety strip	1,000	10,000
50632	Red, .27 safety strip	1,000	10,000

PINS



**Strip Design
Eliminates Jams!**

PA351 PINS (ALSO FITS DX350 AND DX460)

8MM HEAD DIAMETER DRIVE PINS

CAT. NO.	SHANK LENGTH	SHANK DIA.	STD. BOX	STD. CTN.
50240	5/8" (16mm) (K)	.145	500	2,500
50242	3/4" (19mm) (K)	.145	500	2,500
50244	3/4" (19mm) (K)	.145	500	2,500
50246	7/8" (22mm) (K)	.145	500	2,500
50248	1" (27mm) (K)	.145	500	2,500
50250	1-1/4" (32mm) (K)	.145	500	2,500
50252	1-1/2" (37mm) (K)	.145	500	2,500
50254	1-5/8" (42mm) (K)	.145	500	2,500



8MM HEAD COLLATED SPIRAL CSI DRIVE PINS

FOR CONCRETE, STEEL AND I-BEAMS (COMPETES WITH XU PINS)

CAT. NO.	SHANK LENGTH	HEAD DIA.	SHANK DIA.	STD. BOX	STD. CTN.
50450	5/8" (16mm) (K)	8mm	.157	500	2,500
50452	3/4" (19mm) (K)	8mm	.157	500	2,500
50454	7/8" (22mm) (K)	8mm	.157	500	2,500
50456	1" (27mm) (K)	8mm	.157	500	2,500
50458	1-1/4" (32mm) (K)	8mm	.157	500	2,500
50460	1-1/2" (37mm) (K)	8mm	.157	500	2,500
50461	1-5/8" (42mm) (K)	8mm	.157	500	2,500

(K) - knurled



Tool Kit Cat. No. 50266

TOOL KIT INCLUDES

- Safety Glasses, Disposable Ear Plugs
- Allen Wrenches, Wire Brushes, Tool Lubricant
- Spall Guard, Spare Parts
- Pin Starter Kit
- † .300 Head 10 Fastener Magazine: (50) 3/4", (50) 1", (50) 1-1/2"

ACCESSORIES

- 52041 6' Smacker Pole Tool (Universal Bump Tool)
- 50065 Standard 6' Pole Tool (Trigger Style)
- 50066 Standard 8' Pole Tool (Trigger Style)

REPLACEMENT PARTS (1 EACH)

Can be ordered separately

- 52133 PA351 Piston with Ring
- 52137 Base Plate 2/S-13
- 52135 Guide 2/F-3
- 52141 Magazine

For additional spare parts please reference the tool manual or Powers' Buyers Guide.



HEAVY DUTY
 • .27 Caliber
 • 10 Load Strip
 • 3" Pin Capacity

P3600

The P3600 is a low velocity, semi-automatic .27 caliber tool which can be used to install 3/8" head drive pins, 10mm head drive pins and 1/4"-20 or 3/8" - 16 threaded studs, up to 3" in total length. The P3600 is designed for high speed, durability and repetitive volume applications.

APPLICATIONS

- Threaded Studs to Concrete
- Wood to Concrete
- Metal Track to Concrete
- Electrical Fixture to Concrete
 - Electrical Fixture to Steel
 - Concrete Forming
 - Commercial / Residential Construction



Tool Kit Cat. No. 52010

TOOL KIT INCLUDES

- Safety Glasses, Disposable Ear Plugs
- Allen Wrenches, Wire Brushes, Tool Lubricant
- Spall Guard, Spare Parts
- Pin Starter Kit
 - † 10mm Headed Pins: (15) 1", (15) 1-5/8", (15) 2"

REPLACEMENT PARTS (1 EA.)

Can be ordered separately

52578 Piston Ring

For additional spare parts please reference the tool manual or Powers' Buyers Guide.

ACCESSORIES

- 52041 6' Smacker Pole Tool (Universal Bump Tool)
- 50065 Standard 6' Pole Tool (Trigger Style)
- 50066 Standard 8' Pole Tool (Trigger Style)

PINS



10MM HEAD DRIVE PINS FOR CONCRETE

CAT. NO.	SHANK LENGTH	HEAD DIA.	SHANK DIA.	STD. BOX	STD. CTN.
50846	19mm - 3/4"	10mm	.177	100	5,000
50848	22mm - 7/8"	10mm	.177	100	5,000
50850	27mm - 1"	10mm	.177	100	5,000
50852	32mm - 1-1/4"	10mm	.177	100	5,000
50854	42mm - 1-5/8"	10mm	.177	100	5,000
50856	52mm - 2"	10mm	.177	100	5,000
50858	62mm - 2-1/2"	10mm	.177	100	1,000
50860	72mm - 2-7/8"	10mm	.177	100	1,000
50862	82mm - 3-1/4"	10mm	.177	100	1,000

DRIVE PIN SIZES

3/8" HEAD DIAMETER DRIVE PINS

CAT. NO.	SHANK LENGTH	SHANK DIA.	STD. BOX	STD. CTN.
50162	1"	.171	100	1,000
50164	1-1/4"	.171	100	1,000
50166	1-1/2"	.171	100	1,000
50170	2"	.171	100	1,000
50172	2-1/2"	.171	100	1,000
50174	3"	.171	100	1,000
50176	3-1/8"	.216/.188	100	1,000

STUDS



THREADED STUDS SIZES

1/4" - 20 THREADED STUDS					
CAT. NO.	THREAD LENGTH	SHANK LENGTH	SHANK DIA.	STD. BOX	STD. CTN.
50320	1/2"	1/2" (K)	.145	100	5,000
50322	3/4"	1/2" (K)	.145	100	1,000
50326	3/4"	3/4"	.145	100	1,000
50328	1/2"	1"	.145	100	1,000
50330	3/4"	1"	.145	100	1,000
50334	1/2"	1-1/4"	.145	100	1,000
50336	3/4"	1-1/4"	.145	100	1,000
3/8" - 16 THREADED STUDS					
CAT. NO.	THREAD LENGTH	SHANK LENGTH	SHANK DIA.	STD. BOX	STD. CTN.
50340	1-1/4"	3/4" (K)	.205	100	1,000
50342	1-1/4"	1"	.205	100	1,000
50344	1-1/4"	1-1/4"	.205	100	1,000

(K) - knurled

LOADS

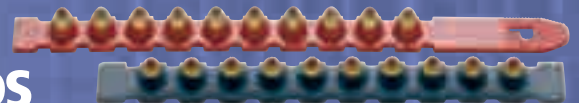

.27 CALIBER SAFETY STRIP® FOR POWERS P3500, PA3500, PA351, RAMSET® SA270, VIPER, HILTI® DX350, DX351, DX36M, AND DX451

CAT. NO.	DESCRIPTION	STD. BOX	STD. CTN.
50620	Brown, .27 safety strip	100	1,000
50622	Green, .27 safety strip	100	1,000
50626	Yellow, .27 safety strip	100	1,000
50630	Red, .27 safety strip	100	1,000
.27 CALIBER 10 LOAD STRIPS - MASTER PACK			
50624	Green, .27 safety strip	1,000	10,000
50628	Yellow, .27 safety strip	1,000	10,000
50632	Red, .27 safety strip	1,000	10,000
50606	Red, .27 strip	1,000	10,000

P-60

The P-60 is a low velocity, powder actuated tool that uses .25 caliber, 10 shot circular disc loads, and is specifically designed for .300 head pin applications into concrete or steel. Shoots a 2-3/8" pin, 2-1/2" pin with washer or threaded stud 1/4-20 up to 1".

HEAVY DUTY

- .25 Caliber
- 10 Load Disc
- 2-3/8" Pin Capacity



FEATURES & BENEFITS

- Adjustable power-one load level for multiple applications
- Tough body construction resists heat transfer
- Resilient handle absorbs recoil
- Cycle tool to advance the load



Tool Kit Cat. No. 52057

TOOL KIT INCLUDES

- P-60 Tool
- Safety Glasses
- Wire Brushes
- Tool Lubricant



PINS



DRIVE PINS SIZE

.300 HEAD DIAMETER DRIVE PINS					
CAT. NO.	SHANK LENGTH	HEAD DIAMETER	SHANK DIA.	STD. BOX	STD. CTN.
50042	2-3/8"	.300	.145	100	1,000
50098	2-1/2"	.300	.145	100	1,000

STUDS



THREADED STUDS SIZES

1/4" -20 THREADED STUDS					
CAT. NO.	THREAD LENGTH	SHANK LENGTH	SHANK DIA.	STD. BOX	STD. CTN.
50320	1/2"	1/2" (K)	.145	100	5,000
50322	3/4"	1/2" (K)	.145	100	1,000
50326	3/4"	3/4"	.145	100	1,000
50328	1/2"	1"	.145	100	1,000
50330	3/4"	1"	.145	100	1,000

LOADS



.25 CALIBER DISK LOADS

CAT. NO.	DESCRIPTION	STD. BOX	STD. CTN.
50530*	Gray, .25 disk	100	1,000
50532	Brown, .25 disk	100	1,000
50534	Green, .25 disk	100	1,000
50536	Yellow, .25 disk	100	1,000
50538	Red, .25 disk	100	1,000

*While supplies last



Sniper™ Pole Tool

The Sniper™ Pole Tool is ideally suited to installing overhead ceiling clips with a 1-1/2" pin. It features high production bump-and-move firing plus a 10 load strip. The Sniper also features Safety Sequence Strip Loading, allowing load advancement only after the pin has been installed in the nose piece, and the handle must be clicked to advance the next load.

Sniper can reach 8 feet in length!

Barrel retention collar designed for easy assembly and disassembly for cleaning and lubrication

Knurled screw-in connector attaches quickly and securely to extension pole

Sniper accommodates a 10 load strip, to keep you moving faster

THE SNIPER POLE TOOL (BUMP TOOL)

CAT. NO.	DESCRIPTION	STD. BOX
52051	Sniper Tool (Bump Tool)	1
52053	6 ft. Pole	1
52061	8 ft. Pole	1

Powder Actuated Pole Tools

Take your powder actuated tools to new heights with the new adjustable extension system called the Smacker. Smacker's center pole section is 6 feet in length, and additional 3 foot extensions can be added up to a total of 12 feet. It features high production bump-and-move firing. The universal cradle accommodates five different Powers' tools and can be changed quickly and easily.

Powers Pole Tool fits four powder actuated models, and is activated by a squeeze trigger. The tool comes in two convenient sizes.

Fits the following Powers tools:

Fits the following Powers tools:

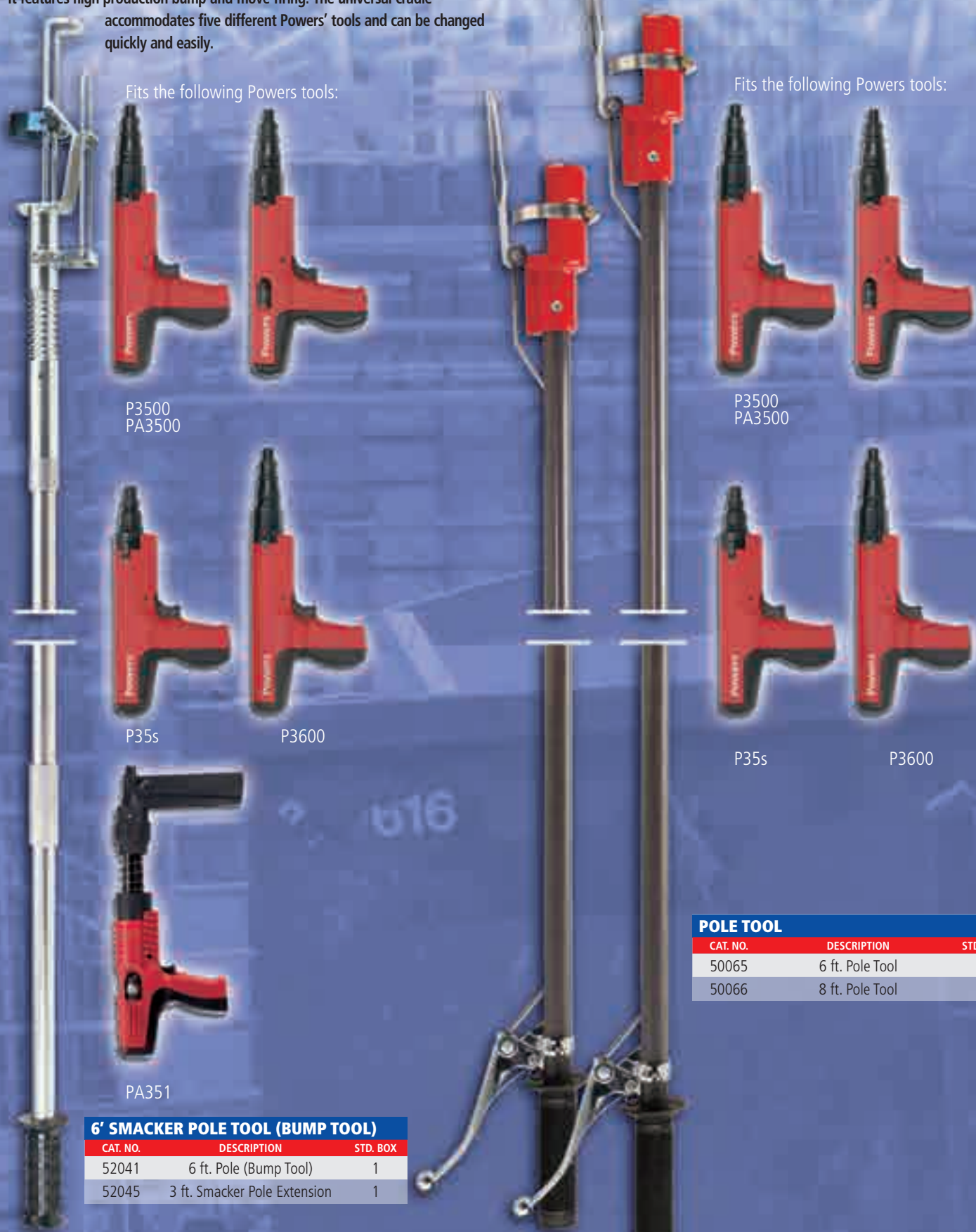

P350
PA3500

P350
PA3500

P35s

P3600

P35s

P3600

PA351

POLE TOOL		
CAT. NO.	DESCRIPTION	STD. BOX
50065	6 ft. Pole Tool	1
50066	8 ft. Pole Tool	1

6' SMACKER POLE TOOL (BUMP TOOL)		
CAT. NO.	DESCRIPTION	STD. BOX
52041	6 ft. Pole (Bump Tool)	1
52045	3 ft. Smacker Pole Extension	1

Merchandising

Merchandisers can act like a round-the-clock salesman in your facility. Our powder actuated display can be loaded with the specific mix of product best suited to your needs, and will keep them organized, neat and readily available.



This custom Merchandiser displays sample powder actuated tools for the customer's inspection.

MERCHANDISING DISPLAY		
CAT. NO.	DESCRIPTION	STD. BOX
49114	Powder Display Rack	1

8MM Pins, Specialty Fasteners, Assemblies and Powder Loads



CEILING CLIP ASSEMBLIES

.300 DIAMETER HEAD PINS WITH CEILING CLIPS					
CAT. NO.	SHANK LENGTH	SHANK DIA.	WIRE HOLE	STD. BOX	STD. CTN.
50363**	1"	.145	0.278"	100	1,000
50364	1"	.145	0.278"	100	1,000
50368	1"	.145	0.278"	100	1,000
50370	1-1/4"	.145	0.278"	100	1,000
50374*	1-1/4"	.145	0.278"	100	1,000

*Economy Clip **No Dome

8MM DRIVE HEAD PINS WITH CEILING CLIPS

CAT. NO.	DESCRIPTION SHANK LENGTH	SHANK DIA.	WIRE HOLE	STD. BOX	STD. CTN.
50272	27mm w/CC	.145	0.278"	100	1,000
50274	32mm w/CC	.145	0.278"	100	1,000



8MM DIAMETER HEAD DRIVE PIN WITH CEILING CLIP FOR HARD AGGREGATE CONCRETE

CAT. NO.	SHANK LENGTH	SHANK DIA.	WIRE HOLE	STD. BOX	STD. CTN.
50206	1-1/4"	100	1,000	.177"	0.278"

.300 DIAMETER PRE-ASSEMBLED PIN AND CLIP FOR LADD TOOL

CAT. NO.	DESCRIPTION	SHANK DIA.	WIRE HOLE	STD. BOX	STD. CTN.
50438	Pre-assembled Pin & Clip (Ladd)	100	1,000	.155	0.278"



BX AND CONDUIT CLIP ASSEMBLIES

.300 DIAMETER HEAD DRIVE PINS WITH BX CABLE STRAPS

CAT. NO.	DESCRIPTION	SHANK DIA.	STD. BOX	STD. CTN.
50150	1"	.145	100	1,000
50152	1-1/4"	.145	100	1,000

.300 DIAMETER HEAD DRIVE PINS WITH CONDUIT CLIPS

CAT. NO.	DESCRIPTION	STD. BOX	STD. CTN.	SHANK DIA.
50380	1/2" EMT 1-1/4"	.145	100	1,000
50381*	1/2" EMT 1" pin	.145	100	1,000
50382	1/2" EMT 1" pin	.145	100	1,000
50384	3/4" EMT 1-1/4"	.145	100	1,000
50386	3/4" EMT 1" pin	.145	100	1,000
50388	1" EMT 1" pin	.145	25	250

* With Top Hat

8MM DIAMETER HEAD DRIVE PINS WITH CONDUIT CLIPS

CAT. NO.	DESCRIPTION	SHANK DIA.	STD. BOX	STD. CTN.
50276	27mm with 1/2" EMT	.145	100	1,000
50278	27mm with 3/4" EMT	.145	100	500
50280	27mm with 1" EMT	.145	25	250

BALLISTIC POINT DRIVE WITH CEILING CLIP

CAT. NO.	DESCRIPTION	HEAD DIA.	SHANK DIA.	STD. BOX	STD. CTN.
50058	1-1/4" with ceiling clip	.300	.181/.150	100	1,000



8MM DIAMETER HEAD PINS WITH ROD HANGER CLIP

CAT. NO.	DESCRIPTION	SHANK DIA.	STD. BOX	STD. CTN.
50219	32mm (1-1/4") pin with 1/4 - 20 rod hanger	.145	100	1,000
50221	32mm (1-1/4") pin with 3/8 - 16 rod hanger	.145	100	1,000



REBAR BASKET ASSEMBLIES

8MM DIAMETER HEAD DRIVE PINS WITH REBAR BASKET CLIP

CAT. NO.	DESCRIPTION	SHANK DIA.	STD. BOX	STD. CTN.
50702	32mm w/ basket clip	.145	100	100
50704	37mm w/ basket clip	.145	100	100
50710	47mm w/ basket clip	.145	100	100
50712	52mm w/ basket clip	.145	100	100
50716	62mm w/ basket clip	.145	100	100
50718	72mm w/ basket clip	.145	100	100



FORMING PINS

CAT. NO.	DESCRIPTION	HEAD DIA.	SHANK DIA.	STD. BOX	STD. CTN.
50789	44mm - 1-3/4"	.205	.145	100	1,000
50790	62mm - 2-1/2"	.205	.145	100	1,000

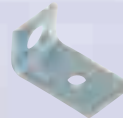

FASTENER ACCESSORIES

CAT. NO.	DESCRIPTION	STD. BOX	STD. CTN.
50400	Ceiling Clip (no pin) 9/32" and 5/16" holes	100	1,000
50439	LADD Clip - No pin	100	1,000
50365	Domed Ceiling Clip - No pin	100	1,000



8MM Pins, Specialty Fasteners, Assemblies and Powder Loads



8MM HEAD COLLATED SPIRAL CSI DRIVE PINS

FOR CONCRETE, STEEL AND I-BEAMS (COMPETES WITH XU PINS)

CAT. NO.	SHANK LENGTH	HEAD DIA.	SHANK DIA.	STD. BOX	STD. CTN.
50450	5/8" (16mm) (K)	8mm	.157	500	2,500
50452	3/4" (19mm) (K)	8mm	.157	500	2,500
50454	7/8" (22mm) (K)	8mm	.157	500	2,500
50456	1" (27mm) (K)	8mm	.157	500	2,500
50458	1-1/4" (32mm) (K)	8mm	.157	500	2,500
50460	1-1/2" (37mm) (K)	8mm	.157	500	2,500
50461	1-5/8" (42mm) (K)	8mm	.157	500	2,500

(K) - knurled



8MM HEAD COLLATED DRIVE PINS FOR DX460

10 FASTENER MAGAZINE

CAT. NO.	SHANK LENGTH (INCHES)	SHANK LENGTH (MM)	SHANK DIA.	STD. BOX	STD. CTN.
50250	1-7/8"	47	.145	500	2,500
50258	2"	52	.145	500	2,500
50260	2-1/4"	57	.145	500	2,500
50262	2-1/2"	62	.145	500	2,500
50264	2-7/8"	72	.145	500	2,500



300" HEAD BLUE MAGIC™ DRIVE PINS

CAT. NO.	SHANK LENGTH (INCHES)	SHANK DIA.	STD. BOX	STD. CTN.
56000	1/2"	0.145	100	5,000
56004	3/4"	0.145	100	5,000
56006	1"	0.145	100	5,000
56012	1-1/2"	0.145	100	1,000



BALLISTIC POINT™ DRIVE PINS (POWER POINT TYPE FASTENERS)

.300 DIAMETER BALLISTIC POINT DRIVE PINS (BLACK)

CAT. NO.	SHANK LENGTH	SHANK DIA.	STD. BOX	STD. CTN.
50052	1/2"	0.150	100	1,000
50053	5/8"	0.150	100	1,000
50054	3/4"	0.150	100	1,000
50055	1"	0.150	100	1,000

BALLISTIC POINT STEP SHANK DRIVE PINS (BLACK)

CAT. NO.	SHANK LENGTH	SHANK DIA.	STD. BOX	STD. CTN.
50056	1-1/4"	.181/.150	100	1,000
50057	1-1/2"	.181/.150	100	1,000



THREADED STUDS SIZES

1/4" -20 THREADED STUDS

CAT. NO.	THREAD LENGTH	SHANK LENGTH	SHANK DIA.	STD. BOX	STD. CTN.
50320	1/2"	1/2" (K)	.145	100	5,000
50322	3/4"	1/2" (K)	.145	100	1,000
50326	3/4"	3/4"	.145	100	1,000
50328	1/2"	1"	.145	100	1,000
50330	3/4"	1"	.145	100	1,000
50334	1/2"	1-1/4"	.145	100	1,000
50336	3/4"	1-1/4"	.145	100	1,000

3/8" -16 THREADED STUDS

CAT. NO.	THREAD LENGTH	SHANK LENGTH	SHANK DIA.	STD. BOX	STD. CTN.
50340	1-1/4"	3/4" (K)	.205	100	1,000
50342	1-1/4"	1"	.205	100	1,000
50344	1-1/4"	1-1/4"	.205	100	1,000



8MM Pins, Specialty Fasteners, Assemblies and Powder Loads



8MM HEAD DRIVE PINS (X-DN TYPE PINS)

8MM HEAD DIAMETER DRIVE PINS

CAT. NO.	SHANK LENGTH	SHANK DIA.	STD. BOX	STD. CTN.
50180	16mm (K) -5/8"	.145	100	5,000
50180	16mm (K) -5/8"	.145	100	5,000
50182	19mm (K) -3/4"	.145	100	5,000
50184	22mm -7/8"	.145	100	5,000
50186	27mm -1"	.145	100	5,000
50188	32mm -1-1/4"	.145	100	1,000
50190	37mm -1-1/2"	.145	100	1,000
50192	42mm -1-5/8"	.145	100	1,000
50194	47mm -1-7/8"	.145	100	1,000
50196	52mm -2"	.145	100	1,000
50198	57mm -2-1/4"	.145	100	1,000
50200	62mm -2-1/2"	.145	100	1,000
50202	72mm -2-7/8"	.145	100	1,000

8MM DIAMETER HEAD DRIVE PINS WITH TOP HAT

50210	16mm (K) -5/8"	.145	100	5,000
50214	22mm -7/8"	.145	100	5,000
50216	27mm -1"	.145	100	5,000

(K) - knurled

8MM DIAMETER HEAD DRIVE PINS WITH TOP HAT

CAT. NO.	SHANK LENGTH	SHANK DIA.	STD. BOX	STD. CTN.
51700	16mm (K) Top Hat	.145	1,000	5,000
51750	22mm Top Hat	.145	1,000	5,000

8MM DIAMETER HEAD DRIVE PINS WITH 1" WASHER

50220	27mm-1"	.145	100	1,000
50222	32mm-1-1/4"	.145	100	1,000
50224	37mm -1-1/2"	.145	100	1,000
50226	52mm-2"	.145	100	1,000
50228	62mm-2-1/2"	.145	100	1,000
50230	72mm-2-7/8"	.145	100	1,000

(K) - knurled



HAMMER DRIVE® PINS (NO POWDER LOADS REQUIRED)

PRODUCT DESCRIPTION

Hammer Drive pins are designed for permanently fastening a fixture to concrete and some types of masonry. This fastener is designed for use in a standard hand tool and should not be used in a powder actuated tool. The pins are formed with a 1/4" diameter head on one end and a 0.140" diameter shank in various lengths. A 3/8" diameter steel washer is mounted over the point to retain the drive pin in the fastener guide of the tool providing guidance during the driving operation. This fastener is recommended for light duty static load applications where holding power is not a critical factor. It should not be used overhead. Federal Specification - Meets the descriptive requirements of FF-P-395 C (superseded).

1/4" HEAD DIAMETER HAMMER DRIVE PINS

CAT. NO.	SHANK LENGTH	SHANK DIA.	STD. BOX	STD. CTN.
50294	3/4"	.140	100	1,000
50296	1"	.140	100	1,000
50298	1-1/4"	.140	100	1,000
50300	1-1/2"	.140	100	1,000
50302	2"	.140	100	1,000
50304	2-1/2"	.140	100	1,000
50306	3"	.140	100	1,000

HAMMER DRIVE SETTING TOOL

CAT. NO.	DESCRIPTION	STD. BOX	STD. CTN.
50310	Hammer Drive Tool - Standard	1	1



.22 CALIBER LOADS FOR LADD CEILING MASTER TOOL (L1600)

CAT. NO.	DESCRIPTION	STD. BOX	STD. CTN.	MASTER CTN.
50514	Green - Ladd	100	5,000	20,000
50516	Yellow - Ladd	100	5,000	20,000
50518	Red - Ladd	100	5,000	20,000



.25 CALIBER LOADS FOR RAMSET® D45, D60, D60L

CAT. NO.	DESCRIPTION	STD. BOX	STD. CTN.	MASTER CTN.
50530	Gray, .25 disk	100	1,000	10,000
50532	Brown, .25 disk	100	1,000	10,000
50534	Green, .25 disk	100	1,000	10,000
50536	Yellow, .25 disk	100	1,000	10,000

.25 CALIBER RED DISK LOADS FOR RAMSET® MODEL D45

50538	Red, .25 disk	100	1,000	10,000
-------	---------------	-----	-------	--------



.25 CALIBER SINGLE LOADS FOR HILTI® DX100, DX200

CAT. NO.	DESCRIPTION	STD. BOX	STD. CTN.	MASTER CTN.
50560	Green, .25 single	100	5,000	20,000
50562	Yellow, .25 single	100	5,000	20,000
50564	Red, .25 single	100	5,000	20,000
50566	Purple, .25 single	100	5,000	20,000



.25 CALIBER 10 LOAD STRIPS FOR P3600 AND MODEL DX 451, DX 40, DX A41

CAT. NO.	DESCRIPTION	STD. BOX	STD. CTN.	MASTER CTN.
50606	Purple, .27 strip	100	1,000	20,000



Powder Actuated Fasteners Performance Data - Ultimate Loads

ULTIMATE LOAD CAPACITIES FOR POWDER ACTUATED FASTENERS IN ASTM A36 STEEL

PIN DESCRIPTION	SHANK TYPE	NOMINAL STEEL THICKNESS							
		1/8"		3/16"		1/4"		3/8"	
		TENSION LBS. (KN)	SHEAR LBS. (KN)	TENSION LBS. (KN)	SHEAR LBS. (KN)	TENSION LBS. (KN)	SHEAR LBS. (KN)	TENSION LBS. (KN)	SHEAR LBS. (KN)
Ballistic Point Pin (0.150" Shank)	Smooth	590 (2.6)	2,090 (9.3)	910 (4.0)	3,030 (13.5)	1,560 (6.9)	2,730 (12.1)	2,250 (10.0)	2,625 (11.7)
0.300" Head Drive Pin	Knurled	1,100 (4.9)	990 (4.4)	1,705 (7.6)	3,050 (13.6)	2,240 (10.0)	2,800 (12.5)	2,600 (11.6)	3,025 (13.5)
8mm Head Drive Pin (0.145" Shank)	Smooth	865 (3.8)	1,325 (5.9)	1,775 (7.9)	2,825 (12.6)	2,050 (9.1)	2,800 (12.5)	2,410 (10.7)	2,620 (11.7)
8mm head CSI Pin (0.157" Shank)	Spiral Knurled	-	-	-	-	4,810 (21.4)	3,199 (14.2)	3,390 (15.1)	2,925 (13.0)
1/4" -20 Threaded Stud (0.145" Shank)	Knurled	1,100 (4.9)	2,230 (9.9)	1,630 (7.3)	2,770 (12.3)	2,160 (9.6)	3,300 (14.7)	2,560 (11.4)	3,760 (16.7)
3/8" Head Drive Pin (0.172" Shank)	Smooth	950 (4.2)	2,700 (12.0)	1,490 (6.6)	3,700 (16.5)	1,820 (8.1)	3,890 (17.3)	3,020 (13.4)	4,230 (18.8)
10mm Head Drive Pin (0.177" Shank)	Smooth	-	-	850 (3.8)	4,150 (18.5)	1,300 (5.8)	4,150 (18.5)	1,900 (8.5)	4,400 (19.6)
3/8"-16 Threaded Stud (0.205" Shank)	Knurled	1,120 (5.0)	2,770 (12.3)	2,700 (12.0)	5,460 (24.3)	3,730 (16.6)	8,090 (36.0)	-	-
Ceiling Clips w/ 0.300" Head Pin (0.145" Shank)	Smooth	1,030 (4.6)	1,190 (5.3)	1,090 (4.8)	1,190 (5.3)	1,090 (4.8)	1,190 (5.3)	1,090 (4.8)	1,190 (5.3)
Economy Ceiling Clips w/ 0.300" Head Pin (0.145" Shank)	Smooth	950 (4.2)	1,290 (5.7)	1,090 (4.8)	1,290 (5.7)	1,090 (4.8)	1,290 (5.7)	1,090 (4.8)	1,290 (5.7)
Ceiling Clips - LADD Pin (0.152" Shank)	Smooth	1,180 (5.2)	1,200 (5.3)	1,180 (5.2)	1,200 (5.3)	1,180 (5.2)	1,200 (5.3)	1,180 (5.2)	1,200 (5.3)

- The ultimate tension and shear values are for fasteners only. Steel or wood members connected to the substrate must be investigated for compliance with the applicable code.
- The values listed above are ultimate load capacities which should be reduced by a factor of safety to determine the allowable working load. For allowable load capacities, see the allowable load tables.
- Fasteners must be driven to obtain an embedment equivalent to the nominal steel thickness with the point of the fastener penetrating through the steel base material.
- Fasteners must be driven to obtain a minimum embedment of 1/2". The point of the fastener does not need to penetrate through the steel base material.
- Multiple fasteners are recommended for any attachment for increased reliability.

ULTIMATE LOAD CAPACITIES FOR POWDER ACTUATED FASTENERS IN ASTM A36 STEEL

PIN DESCRIPTION	SHANK TYPE	NOMINAL STEEL THICKNESS							
		1/8"		3/16"		1/4"		3/8"	
		TENSION LBS. (KN)	SHEAR LBS. (KN)	TENSION LBS. (KN)	SHEAR LBS. (KN)	TENSION LBS. (KN)	SHEAR LBS. (KN)	TENSION LBS. (KN)	SHEAR LBS. (KN)
Ballistic Point Pin (0.150" Shank)	Smooth	590 (2.6)	2,090 (9.3)	910 (4.0)	3,030 (13.5)	1,560 (6.9)	2,730 (12.1)	2,250 (10.0)	2,625 (11.7)
0.300" Head Drive Pin	Knurled	1,100 (4.9)	990 (4.4)	1,705 (7.6)	3,050 (13.6)	2,240 (10.0)	2,800 (12.5)	2,600 (11.6)	3,025 (13.5)
8mm Head Drive Pin (0.145" Shank)	Smooth	865 (3.8)	1,325 (5.9)	1,775 (7.9)	2,825 (12.6)	2,050 (9.1)	2,800 (12.5)	2,410 (10.7)	2,620 (11.7)

- The ultimate tension and shear values are for fasteners only. Steel or wood members connected to the substrate must be investigated for compliance with the applicable code.
- The values listed above are ultimate load capacities which should be reduced by a factor of safety to determine the allowable working load. For allowable load capacities, see the allowable load tables.
- Fasteners must be driven to obtain an embedment equivalent to the nominal steel thickness with the point of the fastener penetrating through the steel base material.
- 8mm head CSI pin and 10mm head drive pin fasteners must be driven to obtain a minimum embedment of 1/2". The point of the fastener does not need to penetrate through the steel base material.
- Multiple fasteners are recommended for any attachment for increased reliability.

ULTIMATE LOAD CAPACITIES FOR POWDER ACTUATED FASTENERS IN MASONRY (F'M ≥ 1,500)^{1,2,3,4}

PIN DESCRIPTION	MIN. EMBED. DEPTH h _e IN. (MM)	HOLLOW CMU				GROUT FILLED CONCRETE MASONRY	
		FACE		FACE		MORTAR JOINT	
		TENSION LBS. (KN)	SHEAR LBS. (KN)	TENSION LBS. (KN)	SHEAR LBS. (KN)	TENSION LBS. (KN)	SHEAR LBS. (KN)
Ballistic Point Pin (0.181"/0.150" Shank)	1 (25.4)	320 (1.4)	740 (3.3)	570 (2.6)	900 (4.1)	510 (2.3)	960 (4.3)
.300"/8mm Head Drive Pin or 1/4"-20 Threaded Stud (0.145" Shank)	1 (25.4)	320 (1.4)	740 (3.3)	570 (2.6)	900 (4.1)	510 (2.3)	960 (4.3)
3/8" Head Drive Pin (0.172" Shank)	1 (25.4)	-	-	740 (3.3)	850 (3.8)	-	3,199 (14.2)
3/8"-16 Threaded Stud (0.205" Shank)	1 (25.4)	160 (0.7)	670 (3.0)	860 (3.9)	1,460 (6.6)	1,060 (4.8)	1,0300 (4.6)

- Successful fastening to the face shell of Hollow CMU is typically done with the lightest powder load level.
- The values listed above are ultimate load capacities which should be reduced by a factor of safety to determine the allowable working load. For allowable load capacities, see the allowable load tables.
- Multiple fasteners are recommended for any attachment for increased reliability.
- Concrete masonry units are typical 8 x 8 x 16 inch units meeting the requirements of ASTM C90, Grade N, lightweight block.

ULTIMATE LOAD CAPACITIES FOR POWDER ACTUATED FASTENERS IN ASTM A572 STEEL^{1,2,3,4,5}

PIN DESCRIPTION	SHANK TYPE	NOMINAL STEEL THICKNESS							
		1/8"		3/16"		1/4"		3/8"	
		TENSION LBS. (KN)	SHEAR LBS. (KN)	TENSION LBS. (KN)	SHEAR LBS. (KN)	TENSION LBS. (KN)	SHEAR LBS. (KN)	TENSION LBS. (KN)	SHEAR LBS. (KN)
10mm Head Drive Pin (0.177" Shank)	Smooth	1,275 (5.7)	3,850 (17.1)	1,075 (4.8)	3,250 (14.5)	1,800 (8.0)	3,900 (17.3)	2,275 (10.1)	4,250 (18.9)
8mm head CSI Pin (0.157" Shank)	Spiral Knurled					3,975 (17.7)	2,900 (12.9)	3,300 (14.7)	2,675 (11.9)

- The ultimate tension and shear values are for fasteners only. Steel or wood members connected to the substrate must be investigated for compliance with the applicable code.
- The values listed above are ultimate load capacities which should be reduced by a factor of safety to determine the allowable working load. For allowable load capacities, see the allowable load tables.
- Fasteners must be driven to obtain an embedment equivalent to the nominal steel thickness with the point of the fastener penetrating through the steel base material.
- 8mm head CSI pin and 10mm head drive pin fasteners must be driven to obtain a minimum embedment of 1/2". The point of the fastener does not need to penetrate through the steel base material.
- Multiple fasteners are recommended for any attachment for increased reliability.

POWERS FASTENERS BRANCH INFORMATION

USA LOCATIONS FOR US CUSTOMER SERVICE

1-800-524-3244

CITY	ADDRESS	PHONE	FAX
Alabama	5405 Buford Hwy Suite 410 Norcross, GA 30071-3984	678-966-0000	678-966-9242
Atlanta	5405 Buford Hwy Suite 410 Norcross, GA 30071-3984	678-966-0000	678-966-9242
Boston	2 Powers Lane, Brewster, NY 10509	800-524-3244	877-871-1965
Charlotte	349 L West Tremont Avenue, Charlotte, NC 28203	704-375-5012	704-376-5517
Chicago	2472 Wisconsin Avenue, Downers Grove, IL 60515	630-960-3156	630-960-3912
Dallas	1300 IH 35 North, Suite #118, Carrollton TX 75006	972-446-5985	972-446-3674
Denver	2475 West Second Street #35, Denver, CO 80223	303-922-9202	303-922-9228
Detroit	21600 Wyoming Avenue, Oak Park, MI 48237	248-543-8600	248-543-8601
Florida	2412 Lynx Lane, Orlando, FL 32804	813-626-4500	813-626-4545
Houston	13833 North Promenade, Suite 100, Stafford, TX 77477	281-491-0351	281-491-0367
Indianapolis	15290 Stony Creek Way, Noblesville, IN 46060	317-773-1668	317-773-1690
Los Angeles	2761 Dow Avenue, Tustin, CA 92780	714-731-2500	714-731-2566
Maryland	3137-B Penny Drive, Landover, MD 20785	301-773-1722	301-341-5119
Milwaukee	12020 W. Feerick Street, Milwaukee, WI 53222	414-466-2400	414-466-3993
Minneapolis	351 Wilson Street, NE Minneapolis, MN 55413	612-331-3770	612-331-3549
Missouri	3225 Harvester Road, Kansas City, KS 66115	816-472-5033	816-472-5040
New Orleans	102 Sampson Street, Houston, TX 77003	713-228-1524	713-228-1528
New York	2 Powers Lane, Brewster, NY 10509	800-524-3244	877-871-1965
Philadelphia	2 Powers Lane, Brewster, NY 10509	800-524-3244	877-871-1965
Phoenix	3602 E. Southern Ave, Suite 5 Phoenix, AZ 85040	602-431-8024	602-431-8027
Pittsburgh	1360 Island Avenue, McKees Rocks, PA 15136	412-771-3010	412-771-9858
Portland	14221 NE 190th St., Suite 125, Woodinville, WA 98072	714-731-2500	714-731-2566
Rochester	36 Van Auken Blvd., Rochester, NY 14608	800-524-3244 / 585-529-4188	877-871-1965 / 585-529-5319
Salt Lake City	3120 W. California Ave, Suite E, Salt Lake City, UT 84104	801-466-9428	801-466-3083
San Francisco	28970 Hopkins Street, Suite B+C, Hayward, CA 94545	510-293-1500	510-293-1505
Seattle	14221 NE 190th St., Suite 125, Woodinville, WA 98072	714-731-2500	714-731-2566
Tennessee	221 Blanton Avenue, Nashville, TN 37210	615-248-2667	615-248-2676

INTERNATIONAL LOCATIONS

COUNTRY/REGION	ADDRESS	CONTACT	PHONE	FAX
Australia	Factory 3, 205 Abbotts Road, Dandenong, South Victoria 3175	Peter Pratis	+61 3 8787 5888	+61 3 8787 5899
Canada	6275 Millcreek Drive, Mississauga, Ontario L5N 7K6	Joe Diilio	1-800-567-7188	1-800-265-9680
China	8/F, Lujiazui Fund Tower, No. 101, Zhu Lin Road, PuDong District, Shanghai, China 200122	Tina Ge	+86-21-6162-1858*2234	+86-21-5080-5101
Europe	Westrak 208, 1771 SV Wieringerwerf, Netherlands	Colin Earl	+31 888 769 377	+31 227 594 759
Manitoba	1810 Dublin Avenue Man. Winnipeg, R3H 0H3	Distributor	204-633-0064	204-694-1261
New Zealand	PO Box 302 076 North Harbour Auckland	Clay Sesto	+64 9415 2425	+64 9415 2627
Quebec	721 Meloche Avenue, Dorval, Quebec H9P 2S5	Allan Hill	514-631-4216	514-631-2583

LATIN & CARIBBEAN DISTRIBUTION INQUIRIES

COUNTRY/REGION	ADDRESS	CONTACT	PHONE	FAX
Latin America		Allan Herbert	0050767477749	877-871-1965

LATIN & CARIBBEAN DISTRIBUTION

COUNTRY/REGION	ADDRESS	CONTACT	PHONE	FAX
Brazil	HARD, Rua Dr. Humberto Pinheiro Viera, 150 Lote B, 1 B Distrito Industrial, Joinville, Brazil		55-47-40097209	55-47-40097217
Colombia	Electrogeno, S.A., Carrera 52 #71c-38, Bogota, Colombia		(57) 1 6600 9436	
Costa Rica	Tecnofijaciones de Costa Rica,, La Uruca, costado Este del Banco Nacional, Condominio Horizontal JW, Bodega #21, San Jose, Costa Rica	alguerak@tecnofijacionescr.com	00-506-2256-8115/8117	00-506-2256-8149
	Cel Internacional s.a., Alajuela, Costa Rica, Apartado 674-4050	ventas@celcr.com	00-506-2432 5868	00-506-2440-1839
Dominican Republic	Calle Estancia Nueva #17 E Esquina Cul-De-Sac 9, San Geronimo, Santo Domingo	Rodfor Team	809-224-5615	809-472-8640
Ecuador	Acero Comercial Ecuatoriano S.A., Av. La Prensa N45-14 y Telégrafo 1 – Quito	info@acero.comercial.com	(593-2) 2454 333	(593-2) 2454 455
	Av. Juan Tanca Marengo Km. 1.7 – Guayaquil	infofy@acero.comercial.com	(593-4) 2683 060	(593-4) 2683 059
Guatemala	Multimateriales s.a., 1 calle, #33-88, Zona 1, Colonia Toledo, Guatemala 01011	info@multimateriales.com	00-502-2429-6700	00-502-2429-6767
Mexico	Multiaccesorios, Av.A tiempo, #502, Parque, Nuevo Leon	jnlazo@multiaccesorios.com	00-52-81-8042-4200	00-52-81-1231-0048
	Fulminantes Industriales, Encino No.1103, Col Granjas, Chihuahua	irmafp@live.com	00-52-614-419-0090	00-52-614-419-8523
	Sergio Paulo Ramirez, Colonia Jardines de Jerez, Gardenias #103, Leon, Guanajuato	prosetgto@hotmail.com	00-52-477-711-0670	00-52-477-212-2478
Panama	Centro-Industrial, Via Cincuentenario, No. 7910, Ciudad Panama, Panama		(507) 302-8022	
	Mecsa, Via Argentina #46-70, Edif. Rattan, Planta Baja Local 5, Panama	rvanselow@germantecpa.com	00-507-269-4333	00-507-269-1866
	Fixa Panama, Via Porras, Edif. 54, Local #7, San Francisco	ventas@fixapanama.com	00-507-260-9505	
Peru	Powers Peruana SAC, Av. Santa Catalina, 571 La Victoria, Lima 13, Peru (www.powersperuana.com)	Martin Vasquez	00 511 265 8500	00 511 330 0909
Venezuela	Anclajes Powers s.a., Calle Sucre/Qta. Maudora, #1721 Entre Cec Acosta Y San Ignacio Chacao, Caracas	Distributor		
		anclajespowers@hotmail.com	58 212 264 1313	58 212 263 0219
Trinidad - Tobago	Ft. Farfan, 3-5 Ibis Avenue, Ibis Acres, San Juan	Derek Cumming	(868) 674-7896	

Note: The information and data contained within this documentation was current as of June 1, 2014. The information is for marketing purposes only and is subject to change and updates as needed. Powers Fasteners, Inc. reserves the right to change designs and specifications without notice or liability for such changes. Please contact Powers Fasteners for the most current and up to date available information or refer to our website at www.powers.com

