

**SUBMITTAL  
DATA**



**S100 & S100U**

**POSITIVE PRESSURE SERIES GAS FIRED  
INFRA-RED TUBE HEATERS**

<b>PROJECT:</b>	
<b>ENGINEER:</b>	
<b>CONTRACTOR:</b>	
<b>DISTRIBUTOR:</b>	
<b>SCHWANK MODEL #:</b>	
<b>FUEL:</b>	N.G.                      L.P.G
<b>APPROVED BY:</b>	
<b>DATE:</b>	
<b>APPROVAL #:</b>	

**NOTICE:**

Schwank reserves the right to make changes to equipment and specifications without obligation or notification.

This publication, or parts thereof, may not be reproduced in any form, without prior written consent from Schwank. Unauthorized use or distribution of this publication is strictly prohibited.

Schwank  
5285 Bradco Blvd.,  
Mississauga, Ontario,  
L4W 2A6

2 Schwank Way  
Waynesboro, Georgia,  
USA 30830

Customer and Technical Services  
Phone: 1-877-446-3727      Email: [csr@schwankgroup.com](mailto:csr@schwankgroup.com)  
Fax : 1-866-361-0523  
[www.schwankgroup.com](http://www.schwankgroup.com)



QTY ON PROJECT	TABLE 1: MODEL CONFIGURATIONS	OVERALL HEATER LENGTH	BTU/HOUR INPUT	TURBULATOR REQUIRED LENGTH	GAS PRESSURE & ELECTRICAL	SHIPPING WEIGHT (LBS.)
	S100 200-70	69' 4"	200,000 Btu/hr 59 Kw	10'	<u>LINE MINIMUM</u> 5" (127 mm) W.C. N.G. 11" (279 mm) W.C. L.P.	240
	S100 200-60	59' 8"		10'		210
	S100 200-50	50' 0"		10'		180
	S100U 200-30	31' 11"		10'		210
	S100 175-70	69' 4"	175,000 Btu/hr 51 Kw	10'		240
	S100 175-60	59' 8"		10'		210
	S100 175-50	50' 0"		10'		180
	S100U 175-30	31' 11"		10'		210
	S100 155-60	59' 8"	150,000 Btu/hr 44 kW	Not Required	<u>LINE MAXIMUM</u> 14" (356 mm) W.C. N.G. 14" (356 mm) W.C. L.P.	210
	S100 155-50	50' 0"		Not Required		180
	S100 155-40	40' 4"		10'		150
	S100U 155-30	31' 11"		Not Required		210
	S100U 155-20	22' 3"		10'		150
	S100 130-50	50' 0"	125,000 Btu/hr 37 kW	Not Required	<u>MANIFOLD</u> 3.5" (89 mm) W.C. N.G. 10" (254 mm) W.C. L.P.	180
	S100 130-40	40' 4"		10'		150
	S100 130-30	30' 8"		14'		120
	S100U 130-20	22' 3"		10'		150
	S100U 130-15	17' 3"		14'		120
	S100 110-50	50' 0"	110,000 Btu/hr 32 kW	Not Required	1/2" (13 mm) INLET	180
	S100 110-40	40' 4"		10'		150
	S100 110-30	30' 8"		14'		120
	S100U 110-20	22' 3"		10'		150
	S100U 110-15	17' 3"		14'		120
	S100 100-20	21' 0"	100,000 Btu/hr 29 kW	10'	ELECTRICAL 120V, 60 HZ	90
	S100 80-40	40' 4"	80,000 Btu/hr 23 kW	10'		150
	S100 80-30	30' 8"		14'		120
	S100 80-20	21' 0"		14'		90
	S100U 80-15	17' 3"		14'		120
	S100U 80-10	12' 7"		14'		90
	S100 60-30	30' 8"	60,000 Btu/hr 18 kW	14'		120
	S100 60-20	21' 0"		14'		90
	S100U 60-10	12' 7"		14'		90
	S100 45-20	21' 0"	45,000 Btu/hr 13 kW	14'		90

NOTE: As required Series S100 / S100U heaters will be supplied with the turbulator snugly installed into the end tube(s) of the system configuration.

## S100 STRAIGHT TUBE SYSTEM

TABLE 2A: COMPONENT QUANTITIES PER HEATER MODEL	S100 45-20	S100 60-20 80-20	S100 100-20	S100 60-30 80-30 110-30 130-30	S100 80-40 110-40 130-40 155-40	S100 110-50 130-50 155-50	S100 175-50 200-50	S100 155-60	S100 175-60 200-60	S100 175-70 200-70
HEATER QUANTITY ON PROJECT										
10' ALUMATHERM TUBE w/ FLANGE	0	0	0	0	0	0	1	0	1	1
10' ALUMINIZED TUBE w/ FLANGE	1	1	1	1	1	1	0	1	0	0
10' ALUMINIZED TUBE	0	0	0	0	0	0	1	0	1	1
10' STEEL TUBE	1	1	1	2	3	4	3	5	4	5
10' REFLECTOR	2	2	2	3	4	5	5	6	6	7
REFLECTOR END CAP	2	2	2	2	2	2	2	2	2	2
TORCTITE COUPLER	1	1	0	2	3	4	3	5	4	5
ACCUSEAL TUBE CLAMP	0	0	1	0	0	0	1	0	1	1
TUBE / REFLECTOR WIRE HANGER	4	4	4	6	8	10	10	12	12	14
5' (1,524 mm) STAINLESS STEEL TURBULATOR	0	0	0	0	0	0	0	0	0	0
10' (3,048 mm) STAINLESS STEEL TURBULATOR	0	0	1	0	0	0	0	0	0	0
10'(3,048 mm) ALUMINIZED STEEL TURBULATOR	1	1	0	1	1	0	1	0	1	1
4' (1,219 mm) ALUMINIZED STEEL TURBULATOR	1	1	0	1	0	0	0	0	0	0

## S100U 'U' TUBE SYSTEM

TABLE 2B: COMPONENT QUANTITIES PER HEATER MODEL	S100U 60-10 80-10	S100U 110- 15 130-15 80-15	S100U 110- 20 130-20 155-20	S100U 175- 30 200-30
HEATER QUANTITY ON PROJECT				
10' (3,048 mm ) ALUMA-THERM TUBE w/ FLANGE	0	0	0	1
10' (3,048 mm) ALUMINIZED TUBE w/ FLANGE	1	1	1	0
10' (3,048 mm) ALUMINIZED TUBE	0	0	0	1
10' (3,048 mm) STEEL TUBE	1	1	3	4
5' (1,524 mm) STEEL TUBE	0	2	0	0
10' (3,048 mm) REFLECTOR	1	2	2	3
5' (1,524 mm) REFLECTOR	0	2	0	0
REFLECTOR END CAP	2	2	2	2
TORCTITE COUPLER	2	4	4	5
ACCUSEAL TUBE CLAMP	0	0	0	1
TUBE / REFLECTOR WIRE HANGER	2	4	4	6
10' ALUMINIZED STEEL TURBULATOR	1	1	1	1
4' ALUMINIZED STEEL TURBULATOR	1	1	0	0
180 DEGREE TURN-AROUND BOX	1	1	1	1

**TABLE 3: APPROVED MINIMUM CLEARANCES TO COMBUSTIBLES**

MODEL  BOTH "STRAIGHT" & "U-TUBE"	SUSPENDED AT AN ANGLE UP TO 45 DEGREES				SUSPENDED HORIZONTALLY		
	D inches	B inches	F inches	C inches	A inches	S inches	C inches
S100(U)/ITB(U) 200	13	6	74	70	14	44	76
S100(U)/ITB(U) 175	12	6	72	68	13	42	74
S100(U)/ITB(U) 155	10	4	50	64	11	34	70
S100(U)/ITB(U) 130	10	3	45	60	10	32	65
S100(U)/ITB(U) 110	9	3	36	54	9	30	60
S100(U)/ITB(U) 80	7	2	31	38	7	24	42
S100(U)/ITB(U) 60	7	2	25	34	7	20	34
S100/ITB 45	7	2	29	32	7	16	32
S100 /ITB 100	10	4	57	68	11	32	68

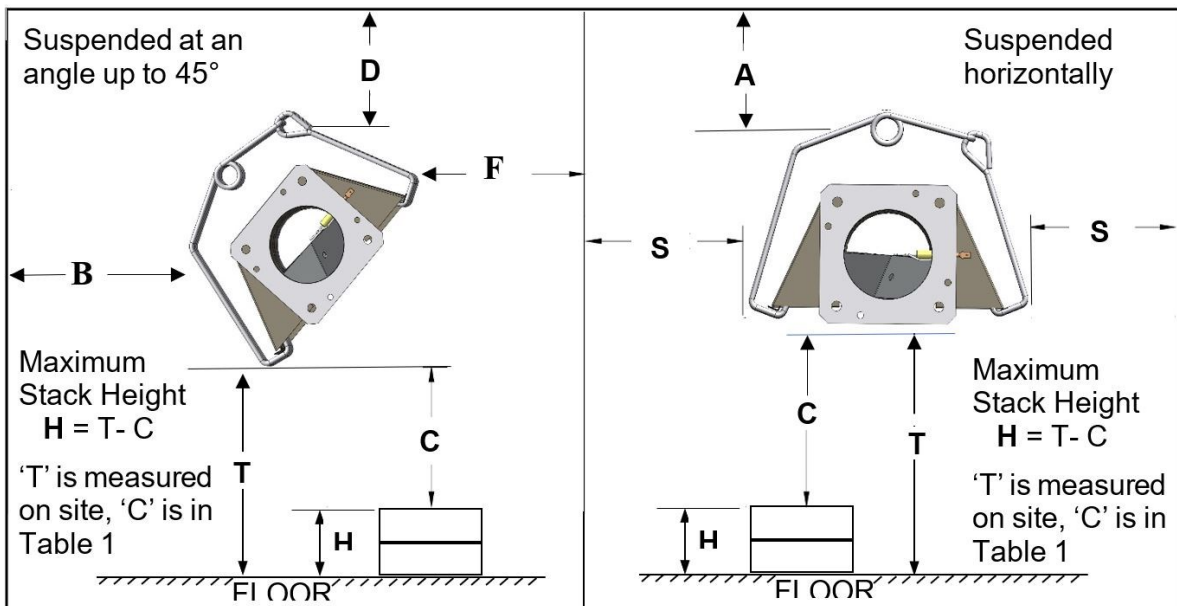

## SECTION DETAILS—STRAIGHT TUBE

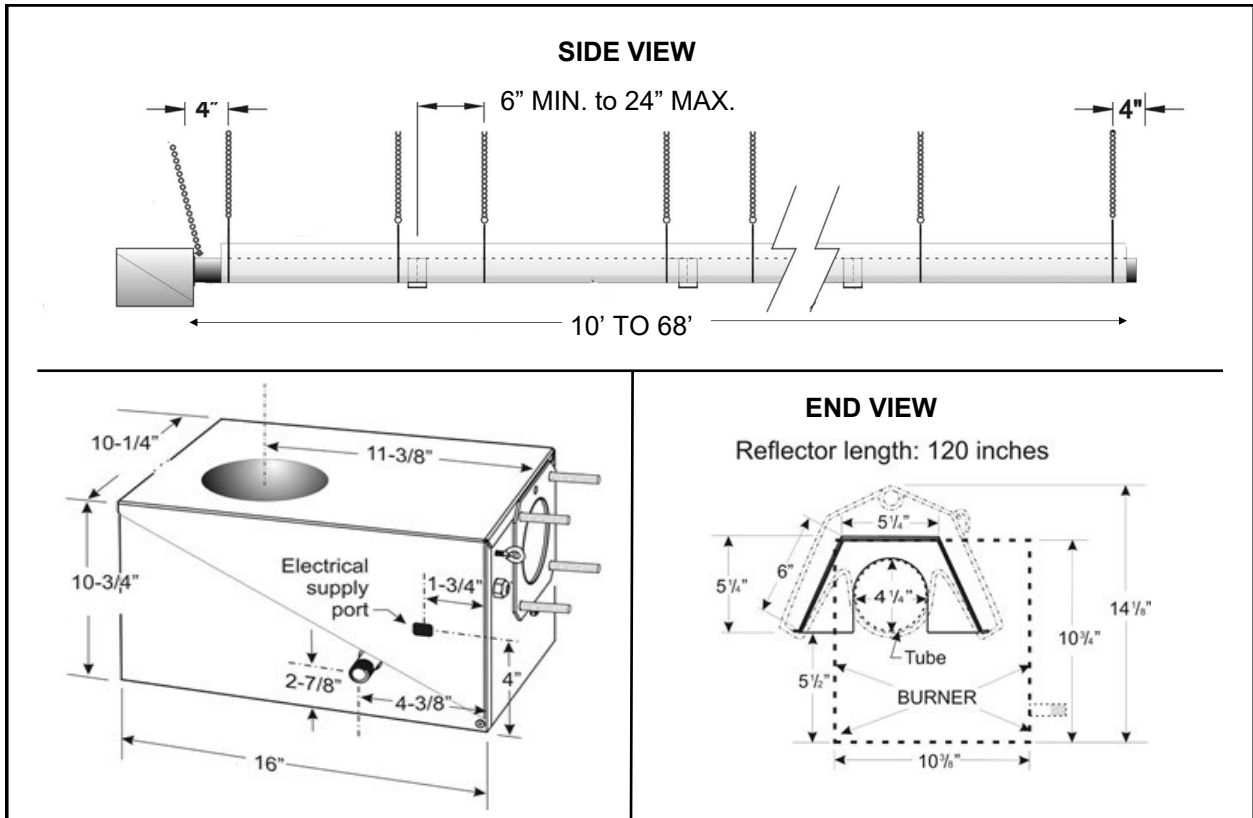

## SECTION DETAILS—'U' TUBE

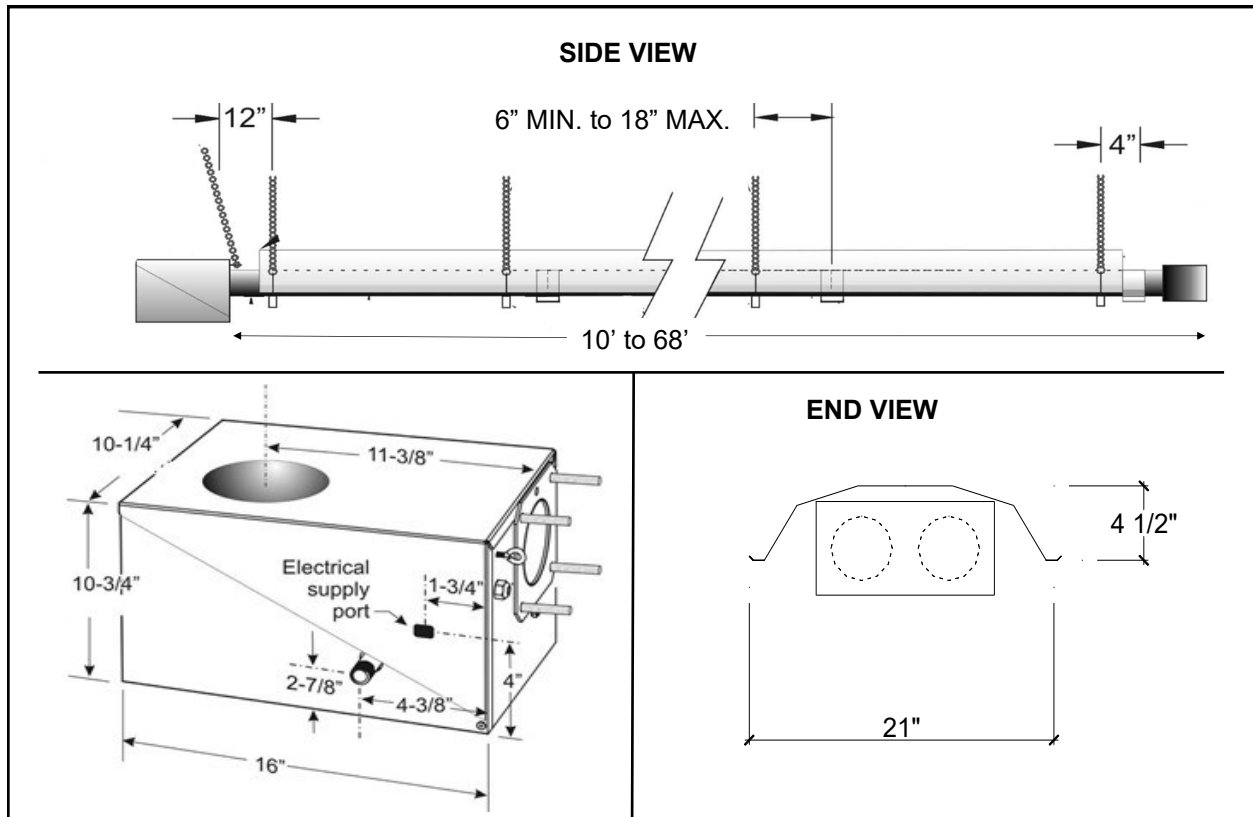

## TOP VIEWS OF SYSTEMS

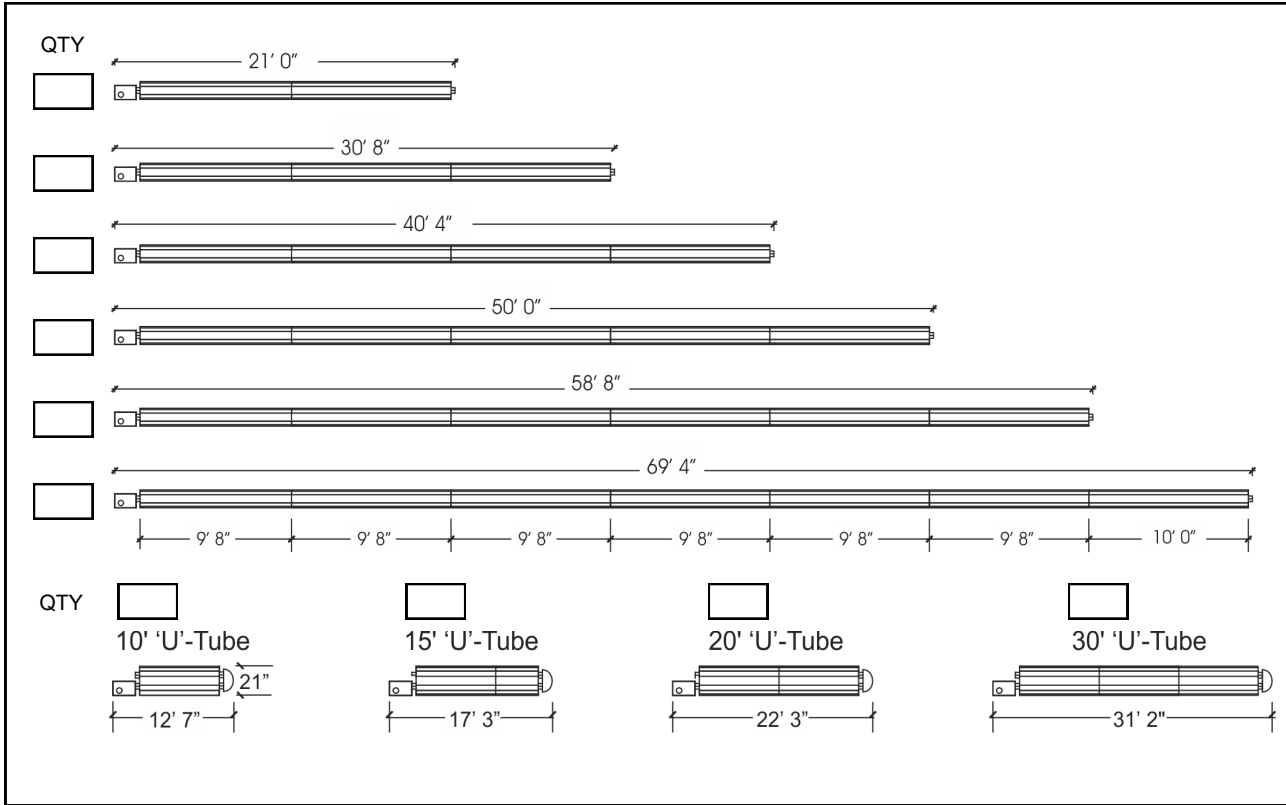

### NOTE:

- CANADA: TYPE 1 HOSE GAS CONNECTOR IS INCLUDED WITH EACH BURNER KIT  
 1/2" x 30" (13mm X 762mm) 45,000 TO 130,000  
 3/4" x 30" (19mm X 762mm) 155,000 TO 200,000
- U.S.A. : FLEXIBLE GAS CONNECTOR IS INCLUDED WITH EACH BURNER KIT  
 1/2" X 24" (13mm X 610mm) 45,000 TO 130,000  
 3/4" X 24" (19mm X 610mm) 155,000 TO 200,000

## CUT-AWAY BURNER VIEW

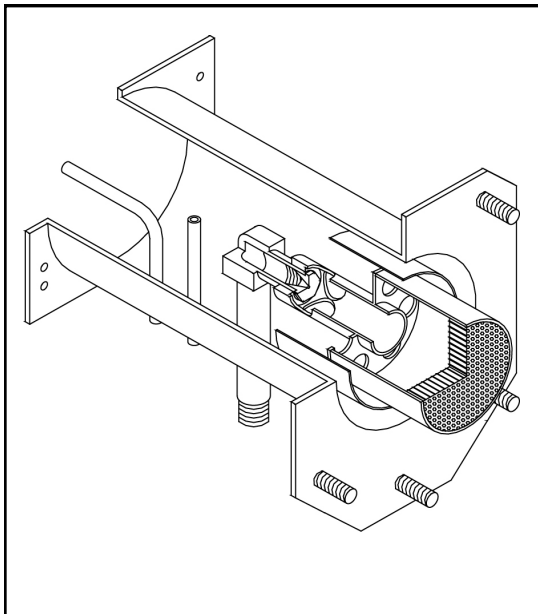

OPTIONAL ACCESSORIES	PROJECT QTY
90 DEGREE ELBOW KIT JS-0508-SM 1 ELBOW, 2 REFLECTOR END CAPS, 1 CLAMP.	
180 DEGREE ELBOW KIT QTY :2 X JS-0508-SM 2 ELBOW, 4 REFLECTOR END CAPS, 2 CLAMP.	
4" (102mm) FRESH AIR INTAKE CAP JS-0532-VC	
4" (102mm) WALL FLUE VENT TERMINAL JA-0528-XX	
FLUE VENT TEE (4" x 4" x 6") JA-0514-AA	
TRU-TEMP THERMOSTAT JM-0150-XX	
THERMOSTAT 24 VOLT DIGITAL JS-0569-WR	

## COMPONENT SPECIFICATIONS

<b>IGNITION</b>	FENWAL DIRECT SPARK MODULE: PRE-PURGE AND POST-PURGE OF TUBE SYSTEM
<b>THERMOSTAT OPTIONS</b> <i>(Factory ready for 24Vac or 120Vac control)</i>	SCHWANK TRU-TEMP (24V) SET BACK THERMOSTAT WITH RADIANT & AMBIENT SENSORS, AND AUTOMATIC UNOCCUPIED SETBACK MODE
	24V DIGITAL THERMOSTAT NOTE: MULTIPLE HEATERS PER 24V THERMOSTAT REQUIRE RELAY CONTROL CENTER KIT
	LINE VOLTAGE THERMOSTAT; <i>Caution: Post-purge feature disabled with 120V thermostat</i>
	THERMOCONTROL PLUS FIELD SUPPLIED THERMOSTAT BY OTHERS
<b>ELBOWS</b>	90 DEGREE ELBOW 4" DIAMETER, 16 GA. ALUMINIZED STEEL, SWAGED ONE END
	180 DEGREE ALUMINIZED STEEL TURN-AROUND BOX WITH ONE SWAGED END. (S100U Series)
<b>HEATER TUBE(S)</b> 45 to 155 MBH	COMBUSTION TUBE: FLANGED 10' x 4" DIAMETER 16 GA. ALUMINIZED STEEL SWAGED ONE END SECOND TUBE: 10' x 4" DIAMETER 16 GA. ALUMINIZED STEEL SWAGED ONE END EACH ADDITIONAL TUBE: 10' x 4" (3048mm X 102mm) DIAMETER, .16 GA. STEEL TUBES WITH HIGH TEMPERATURE EMISSIVE COATING, SWAGED ONE END
<b>HEATER TUBE(S)</b> 175 & 200 MBH	COMBUSTION TUBE: 10' x 4" DIAMETER, 16 GA. 439 STAINLESS STEEL SWAGED ONE END SECOND TUBE: 10' x 4" (3048mm X 102mm) DIAMETER, 16 GA. ALUMINIZED STEEL SWAGED ONE END EACH ADDITIONAL TUBE: 10' x 4" (3048mm X 102mm) DIAMETER, 16 GA. STEEL WITH HIGH TEMPERATURE EMISSIVE COATING SWAGED ONE END
<b>COMBINATION GAS VALVE</b>	HONEYWELL 24 VOLT NATURAL GAS: 3 1/2" W.C. MANIFOLD PROPANE: 10" W.C. MANIFOLD
<b>GAS CONNECTION</b>	USA: FLEXIBLE STAINLESS STEEL GAS CONNECTOR REQUIRED BY CODE: SUPPLIED WITH BURNER
	CANADA: TYPE 1 GAS HOSE CONNECTOR REQUIRED BY CODE: SUPPLIED WITH BURNER
<b>REFLECTORS</b>	26 GA. ALUMINIZED STEEL REFLECTOR 10 FT LENGTH OVERLAP ENTIRE LENGTH OF SYSTEM; S100U x 15 FT MODEL INCLUDES ONE x 10 FT AND ONE x 5 FT REFLECTOR
	REFLECTORS ARE CLOSED AT START AND END OF EACH STRAIGHT RUN OF TUBES BY MEANS OF END PLATE HANGERS
<b>HANGERS</b>	TWO 1/4" PLATED WIRE HANGERS SUPPORT EACH LENGTH OF TUBE / REFLECTOR
<b>COUPLING KIT</b>	ALUMINIZED STEEL COUPLER; STAINLESS STEEL COUPLER FIRST TUBE CONNECTION 175 & 200 MBH
<b>BURNER HOUSING</b>	BOTTOM FOLDS AWAY, PROVIDING ACCESS FROM TWO SIDES, END AND BOTTOM
<b>BURNER</b>	INCORPORATES EFFECTILE CERAMIC BURNER HEAD WITH MINIMUM OF 835 FLAME PORTS
	COMPLETE WITH OPERATION STATUS INDICATOR LIGHTS
<b>TRANSFORMER</b>	120/24VAC; 20VA
<b>SAFETY SWITCHES</b>	TWO SEPARATE AIR PRESSURE SWITCHES SENSE ADEQUATE COMBUSTION AIR AND BLOCKED FLUE
<b>COMBUSTION AIR</b>	COMBUSTION AIR DUCTED DIRECTLY TO 4" COLLAR AT INTAKE OF BLOWER
<b>TERMINAL BLOCK</b>	ALL WIRING CONNECTIONS BY MEANS OF COMMON TERMINAL BLOCK; JUMPER: FOR 120V THERMOSTAT; REMOVE FOR 24V THERMOSTAT
<b>VENT PIPE</b>	ALL VENT PIPE IS FIELD SUPPLIED BY OTHERS; SINGLE WALL VENT PIPE OTHER THAN PORTION THROUGH WALL OR ROOF MAY BE DOUBLE WALL VENT PIPE
<b>ROOF VENT CAPS</b>	FIELD SUPPLIED BY OTHERS TO MATE WITH VENT PIPE