

## FOOT ACTUATED Tub Trim Kits

### SPECIFICATIONS

#### FEATURES:

- Brass strainer body.
- Metal overflow plate, 3.375" wide
- Designed for heavy-duty use in hotels, motels, and rental properties.
- Replaceable drip-proof Buna-N-Seal.
- Adapter bar for changing from two to one-hole overflow plate

#### PATENTS (QuickTrim):

- U.S. Patent 7,503,083 B2; Patents Pending

#### OPERATION:

- Step on stopper to open or close.

#### THREAD SIZE:

- Replacement sizes to fit most bath wastes.



## QuickTrim™ Kit For the FOOT ACTUATED:



See QuickTrim™ spec sheet for more details.

QuickTrim® FA Trim Kit:	69290
CP - Chrome Plated	•
AB - Antique Brass	
AP - Aged Pewter	
BB - Brushed Bronze	
BN - Brushed Nickel	•
BO - Bone	
BS - Biscuit	
BZ - Oil-Rubbed Bronze	•
CB - Chrome Brushed	
NP - Nickel Polished	•
PB - Polished Brass	•
PN - Pearl Nickel	
WH - White	
WI - Wrought Iron	

For More Information Contact:  
**WATCO Manufacturing Company**  
 1220 South Powell Road  
 Independence, MO 64057-2724  
 Ph. 816-796-3900 • FAX 816-796-0875  
 ® [www.watcomfg.com](http://www.watcomfg.com)

See price list for complete item numbers and available options.

When ordering, please specify complete item number and any applicable option codes.



# FOOT ACTUATED TRIM KIT PARTS LIST

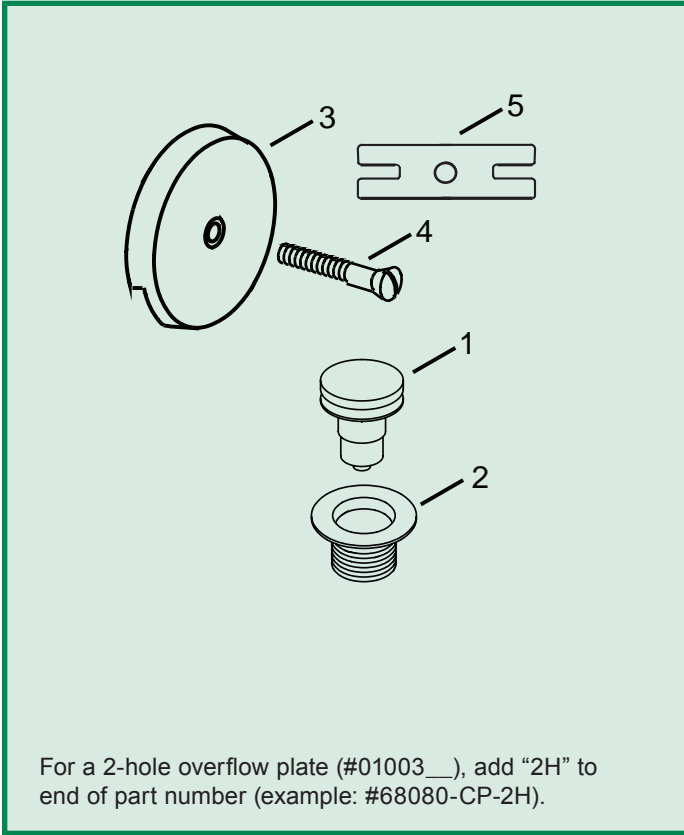

Item	Part #	Description
<b>WITH COARSE-THREAD (11.5) BODY:</b>		
1.	38412__....	Foot Actuated stopper
2.	01016__....	Strainer Body, Brass, CT: 1.865"-11.5-1.25"
3.	01002__....	1-Hole Overflow Plate, metal
4.	01024__....	Overflow Plate Screw, Brass, 2.25"
5.	11641 .....	Adapter Bar, aluminum
<b>WITH FINE-THREAD (16) BODY:</b>		
1.	38412__....	Foot Actuated stopper
2.	01022__....	Strainer Body, Brass, FT: 1.625"-16-1.25"
3.	01002__....	1-Hole Overflow Plate, metal
4.	01024__....	Overflow Plate Screw, Brass, 2.25"
5.	11641 .....	Adapter Bar, aluminum
__ Please indicate desired finish.		

## Finishes Available in the Foot Actuated Series:

Trim Kits:	68080	68190	68290	68390	68490
CP - Chrome Plated	●	●	●	●	●
AB - Antique Brass					
AP - Aged Pewter					
BB - Brushed Bronze					
BN - Brushed Nickel	●	●	●	●	
BO - Bone					
BS - Biscuit					
BZ - Oil-Rubbed Bronze	●	●	●	●	
CB - Chrome Brushed					
NP - Nickel Polished	●	●	●	●	
PB - Polished Brass	●	●	●	●	●
PN - Pearl Nickel					
WH - White					
WI - Wrought Iron					

 For More Information Contact:  
**WATCO Manufacturing Company**  
 1220 South Powell Road  
 Independence, MO 64057-2724  
 Ph. 816-796-3900 • FAX 816-796-0875  
[www.watcomfg.com](http://www.watcomfg.com)